



AIR FIRE TECH

Fire protection systems

FIREREV EI90 / EI60 / EI30

Fire protection access panels



Content

BASICS

Labelling of construction products	6
Fire protection	8
Smoke protection	10
Access doors ≠ Access panels	14
Fire tests	20

FIREREV FOR WALLS

Special features	26
Selection diagram	30
Installation	32

FIREREV for walls with universal installation frame

■ Duo GPS	34
■ Duo VKS	36
■ Duo VKA	38
■ Duo VKA XL	40
■ Basic VKW	42
■ Basic VKW-M for rigid walls	44

FIREREV for walls with EasyFIX-Installation frame

■ Duo GPS-G	46
■ Duo VKS-G	48
■ Basic VKW-G	50
■ Duo GPS-G WC50	52

FIREREV Object for walls

■ Object G	54
■ Object W	56

FIREREV FOR CEILINGS

Special features	60
Installation	62

FIREREV for ceilings

■ Duo DE/GPS	64
■ Duo DE/VKS	66
■ Duo DE/VKA	68
■ Basic DE/VKW-M for rigid ceilings	70

REFERENCES

Further documents from AIR FIRE TECH	72
--------------------------------------	----

Basics





Labelling

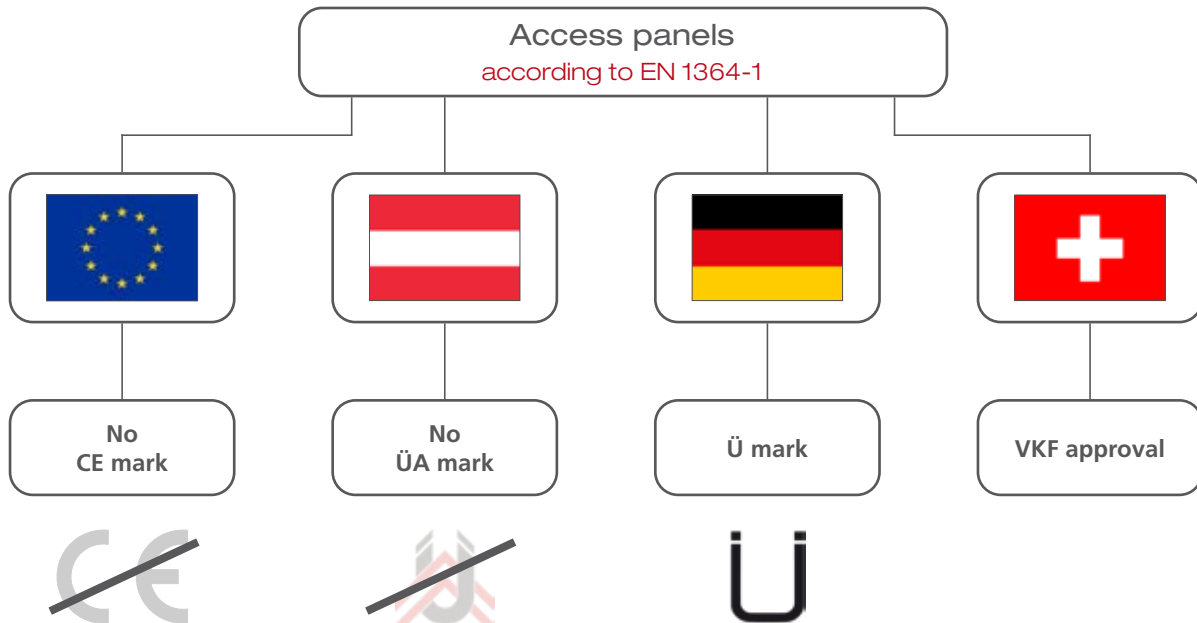

Manufacturer's obligations to provide evidence

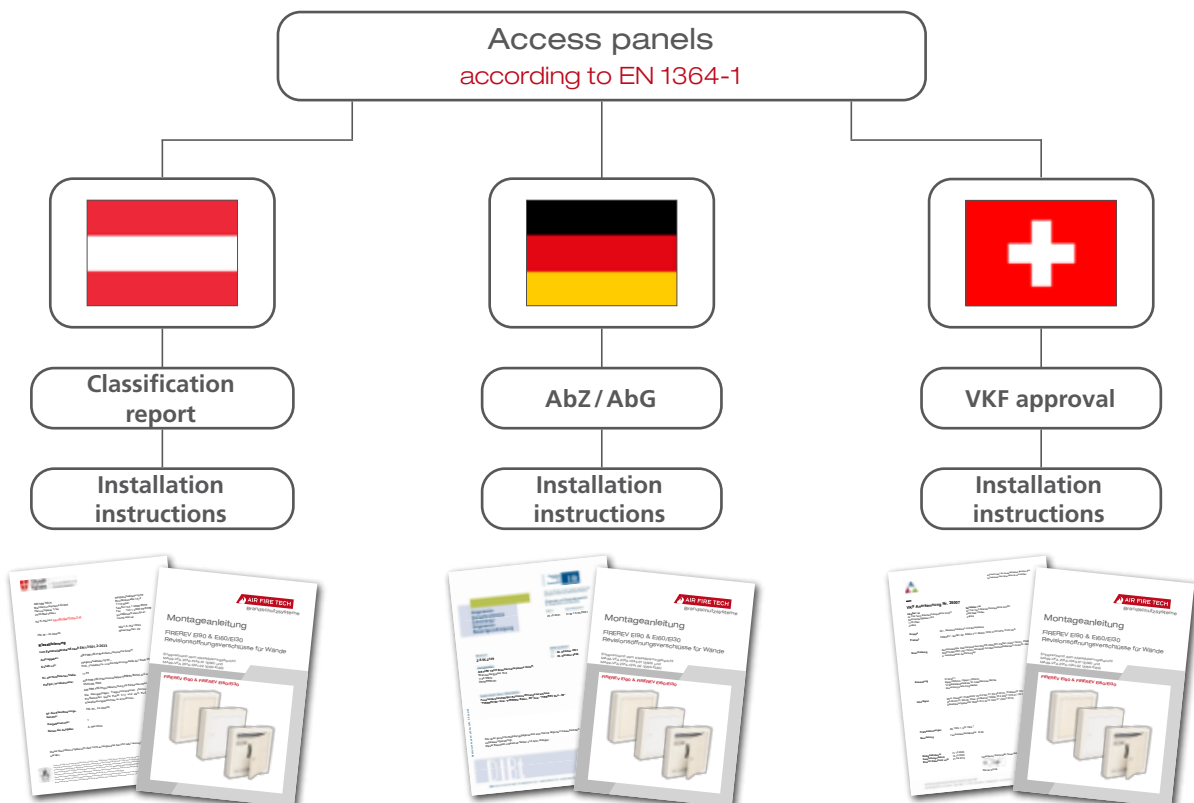

ÖNORM B 3415

Planning and execution of drywall construction work – November 2019 edition

ÖNORM B 3415 applies to the design of non-load-bearing systems made of gypsum boards according to ÖNORM B 3410 and ÖNORM EN 520, as well as to the processing of gypsum boards on the construction site (e.g. gypsum stud walls, suspended ceilings, subsequent attic conversions, component cladding). It also specifies the requirements to be tested.

Fire protection requirements

Excerpt from section 4.3

The following fire protection properties of drywall systems, including their components and materials, as well as of built-in components must be checked:

- **Fire behaviour**
Proof of the fire behaviour class of building materials/construction products must be provided either by specifications in the relevant product standards, or by reference to CWFT decisions of the European Commission (Classified Without Further Testing), or by classification reports according to ÖNORM EN 13501-1.
- **Fire resistance**
In the case of fire protection requirements, the planner must ensure that the systems used meet these requirements. This must be documented and verified. Proof of the fire resistance of drywall systems must be provided by means of a classification report according to ÖNORM EN 13501-2.
- **Connections, installations, feed-throughs**
The planned fire compartments include connections to adjacent components as well as fire barriers for installations, fire dampers for ventilation systems, inspection openings, expansion joints and the like. These must have **the same fire resistance class as the component in which they are installed** and be classified for the same application.

Example:

A 3x15 mm GKF-Shaft wall EI90 requires an access panel with the classification EI90, tested in a 3x15 mm GKF-Shaft wall.

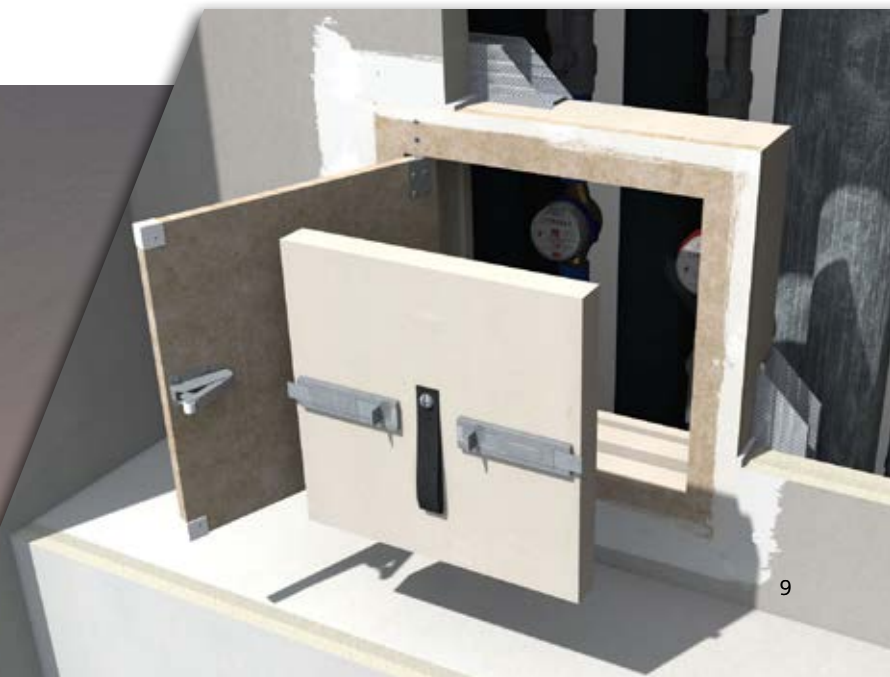

Blower-Door-Test

The Blower-Door-Test is used to determine the airtightness and thus also the smoke tightness of residential and non-residential buildings.



Typical pulling points

- Passages for pipes, cables, sockets
- Connecting points of building materials
- Leakage from installation shafts
- Doors, windows, glass inserts

Measuring device

Viewing window

Blower-Door

Ventilator



More than fire protection



Installation not according to the test certificate

An access panel may only be installed in the manner in which it was tested in the fire test. To this end, the manufacturer must provide **detailed and easily understandable installation instructions**. Without these specifications, installation according to the test certificate is not possible – with possible **consequences for liability, warranty and legal compliance**.

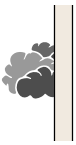

Sealing is mandatory

Shaft walls **must be smoke-tight**. Therefore, when selecting an access panel, it must first be ensured that the selected product meets this requirement. This is the only way to ensure that the structure remains functional and complies with building regulations.

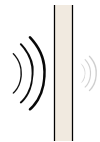

Keep calm

Choosing a high-quality access panel contributes significantly **to maintaining the sound insulation properties of a shaft wall**. This is an essential aspect for a pleasant indoor climate and an important quality feature in modern buildings.

Benefits for everyone involved

Architect



Planning reliability

Compliant selection prevents planning errors and ensures approval eligibility

Planner



Technical compliance

Clear classifications and evidence enable unambiguous specification

Building control



Legal & Verification security

Documented installation instructions and approvals facilitate acceptance

Processor



Installation not according to the test certificate

Simple installation according to the test certificates prevents liability risks

Test standards / Fire resistance

Access panels for shaft walls

EN 1364-1

Edition: 2025-07-01

Fire resistance tests for non-load-bearing components

Part 1: Walls / Part 2: Ceilings

As a construction product that is not regulated in Austria, there is no specific test standard for the fire resistance of access panels. Instead **they are considered part of the wall** and are therefore subject to the test standard for non-load-bearing walls. The test standard used for this purpose is therefore **EN 1364 - Part 1: Walls**.

Sensor arrangement
2 cm from the joint

Maximum temperature rise

■ 180 K

Average temperature rise

● 140 K

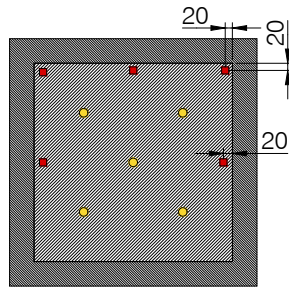

Fire damper air vents "Access doors"

EN 1634-1

Edition: 2018-05-01

Fire resistance tests and smoke protection tests for doors, gates, locks, windows and building hardware

Part 1: Fire resistance tests for doors, gates, locks and windows

The test procedure for access doors is defined by test standard **EN1634-Part 1: Fire resistance tests for doors, gates, locks and windows**. This means that there is a separate test standard for fire resistance.

Sensor arrangement
10 cm from the joint

Maximum temperature rise

■ 180 K

■ 360 K on the frame

Average temperature rise

● 140 K

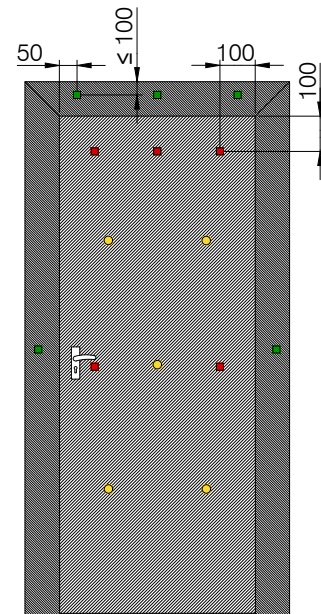

Test standards / Smoke tightness

Access panels for shaft walls

Based on EN 1634-3

Edition: 2007-02-01

Fire resistance and smoke density tests for fire and smoke protection locks, windows and fittings

Part 3: Smoke density tests for smoke control locks

There is currently no specific test standard for determining the smoke tightness of shaft walls with access panels. However, smoke tightness can be determined **according to** test standard **EN 1634-Part 3: Tests for smoke tightness for smoke protection locks**.

Fire damper air vents "Access doors"

According to EN 1634-3

Edition: 2007-02-01

Fire resistance and smoke density tests for fire and smoke protection locks, windows and fittings

Part 3: Smoke density tests for smoke control locks

For access doors, smoke tightness is determined **according to** the test standard **EN 1634-Part 3: Tests for smoke tightness for smoke protection locks**. There is therefore a separate test standard for determining smoke tightness.

Useage According to OIB Guideline 2 "Fire Protection"

OIB-330.2-029/23 – May 2023 edition

Issue: Excerpt from Section 3.4: Shafts, ducts, pipes and other installations

Access panels for shaft walls

3.4.1. If shafts, ducts, pipes and other installations are located in walls or ceilings or penetrate them, suitable measures (e.g. partitioning, sheathing) must be taken to ensure that the spread of fire and smoke is effectively limited for the required fire resistance period.

Installation shaft A

For this purpose, fire damper air vents with the classification EI30 / EI60 / EI90 must be used.

Fire doors "Access doors"

3.4.5 Main distribution boards, floor distribution boards, measuring equipment for electrical installations and inverters for photovoltaic systems in stairwells must be separated by partition elements, with the access openings fitted with a seal in EI₂30-S₂₀₀ or EI30 on all sides.

Floor distributor B

For this purpose, damper air vents with the classification EI₂30 / EI₂60 / EI₂90 must be used.

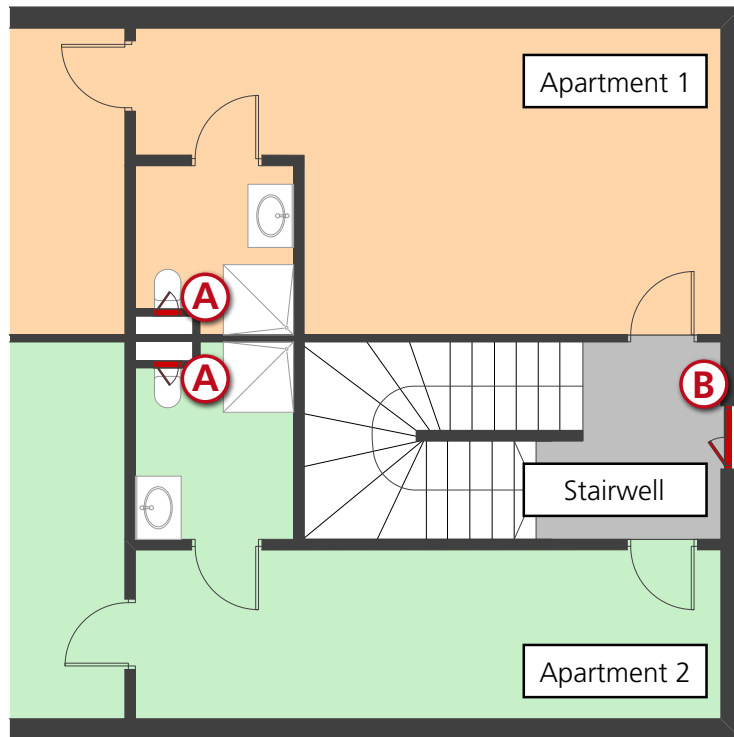

Schematic representation of the floor plan of a residential building

As access panels are considered part of the wall, they must be designed with the same classification as the partition wall according to Table 1b.



OIB Guideline 2 – Point 3.4.2 (see page 14): If shafts connect several storeys, the walls must be constructed as partition walls according to Table 1b.

Overview of building classes GK 1 to GK 5

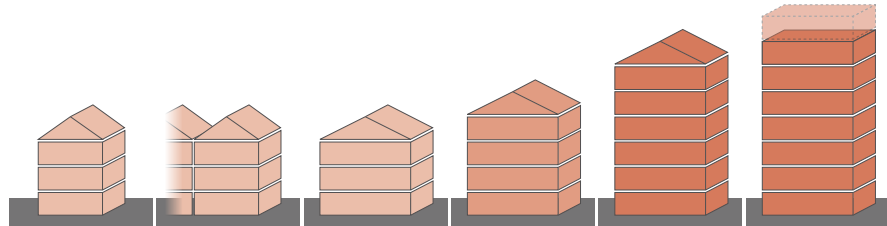

Building classes (GK)	GK 1	GK 2	GK 3	GK 4	GK 5	
Number of above-ground floors	≤ 3	≤ 3	≤ 3	≤ 4	≤ 6	> 6
Escape level (m)	≤ 7	≤ 7	≤ 7	≤ 11	≤ 22	≤ 22
Number of flats or operating units	≤ 2 WHG 1 BE	–	–	1 –	–	–
Gross floor area of the above-ground storeys (m ²)	≤ 400 (free-standing)	≤ 400 (terraced houses) ≤ 800 (detached residential buildings)	–	– each ≤ 400		–

PLEASE NOTE:
For buildings in fire resistance class 5, the shaft walls and access panels must be constructed in EI90!

Excerpt from Table 1b: General requirements for the fire resistance of building components

Building classes (GK)	GK 1	GK 2	GK 3	GK 4	GK 5	
					≤ 6 above-ground storeys	> 6 above-ground storeys
1 load-bearing components (except ceilings and walls forming fire compartments)						
1.1 on the top floor	–	R 30	R 30	R 30	R 60 ⁽⁵⁾	R 60
1.2 in other above-ground floors	R 30 ⁽¹⁾	R 30	R 60	R 60	R 90	R 90 and A2
1.3 in underground floors	R 60	R 60	R 90 and A2	R 90 and A2	R 90 and A2	R 90 and A2
2 partition walls (excluding stairwell walls)						
2.1 on the top floor	–	REI 30 EI 30	REI 30 EI 30	REI 60 EI 60	REI 60 ⁽⁵⁾ EI 60	REI 60 EI 60
2.2 on above-ground floors	–	REI 30 EI 30	REI 60 EI 60	REI 60 EI 60	REI 90 EI 90	REI 90 and A2 EI 90 and A2
2.3 in underground floors	–	REI 60 EI 60	REI 90 and A2 EI 90 and A2	REI 90 and A2 EI 90 and A2	REI 90 and A2 EI 90 and A2	REI 90 and A2 EI 90 and A2
2.4 between flats or operating units in terraced houses	not applicable	REI 60 EI 60	not applicable	REI 60 EI 60	not applicable	not applicable
3 fire compartment walls and ceilings						
3.1 Fire compartment walls only to the neighbouring property or building site boundary	REI 60 EI 60	REI 90 ⁽²⁾ EI 90 ⁽²⁾	REI 90 and A2 EI 90 and A2	REI 90 and A2 EI 90 and A2	REI 90 and A2 EI 90 and A2	REI 90 and A2 EI 90 and A2
3.2 Other fire compartment-forming walls or ceilings	not applicable	REI 90 EI 90	REI 90 EI 90	REI 90 EI 90	REI 90 EI 90	REI 90 and A2 EI 90 and A2
(1) Not required for buildings used solely for residential purposes or for office or office-like use;						
(2) In the case of terraced houses, REI 60 or EI 60 is sufficient for the walls between the flats or business units, even at the boundary to the neighbouring property or building plot boundary;						
(3) For terraced houses and buildings with no more than two operating units used as offices or for office-like purposes, the requirement R 60 is sufficient;						
(4) For individual balconies, a design in R 30 or A2 is sufficient if the area does not exceed 10 m ² , the projection does not exceed 2.50 m and the distance between the individual balconies is at least 2.00 m;						
(5) The fire resistance duration of 60 minutes is sufficient for the two uppermost storeys if all other above-ground floors are constructed to R 90 and A2 or EI 90 and A2 or REI 90 and A2;						
(6) Balcony slabs must be manufactured as full-surface components.						

Our shaft

Technical data sheet of the
Community of Interior Construction
Trades)



The following institutes, associations and companies contributed to the technical data sheet "Our Shaft" and/or provided their graphic illustrations.

IBS Linz / MA 39 / TGM / Wood Research / VÖTB / VÖDU / ÖFV / VÖEH / Air Fire Tech / Knauf / Saint-Gobain Austria

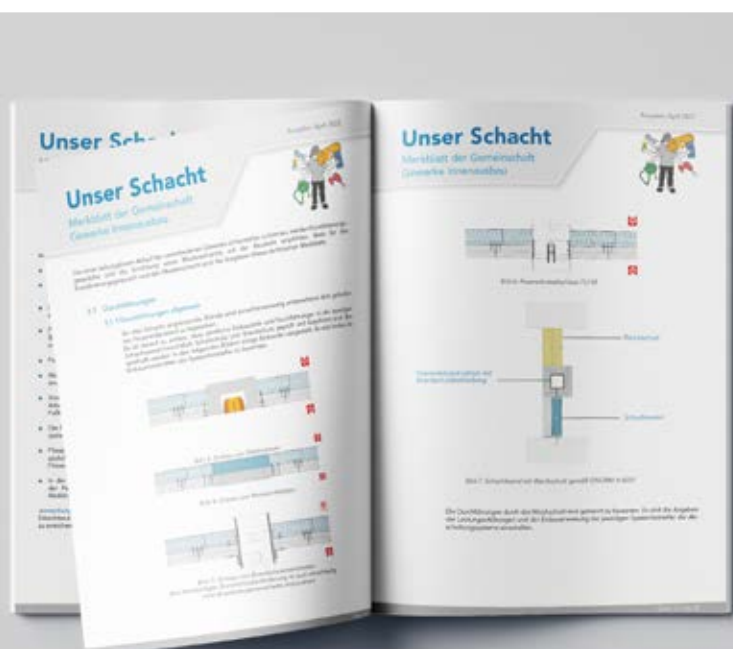

Classification standard / EN 13501-2

EN 13501-2

Edition: 2023-09-01

Classification of construction products and types of construction according to their fire behaviour

Part 2: Classification based on results from fire resistance tests and/or smoke control tests, with the exception of ventilation systems

**Required classification of
access panels**

EI90

**Required classification of
fire damper air vents
"Access doors"**

EI₂90-S₂₀₀

E – Room lock

The ability of a component with a space-dividing function to withstand the stress of a fire attacking only one side in such a way that the fire cannot spread to the unburned side.

I – Thermal insulation for access panels

The ability of a component to resist fire exposure on one side without transferring fire as a result of heat transfer from the fire side to the non-fire side.

I₂ – Thermal insulation for access doors (fire damper air vents)

The classification for thermal insulation must be explicitly carried out using the corresponding indices 1 and 2 according to the two definitions above (e.g. I₂). These indices may only be used for fire protection locks and for locks of conveyor systems and not for any other components with an I classification.

tt – Fire resistance duration in minutes

This is the classification period during which the criteria for room lock and thermal insulation are met.

S – Smoke tightness

The ability of a component to reduce or prevent the passage of gas or smoke from one side of the component to the other.

- **S_a** ...only takes smoke tightness into account at ambient temperatures
- **S₂₀₀** ...takes into account smoke tightness both at ambient temperature and at 200°C.

Suspended ceiling construction

Fire load on the ceiling underside

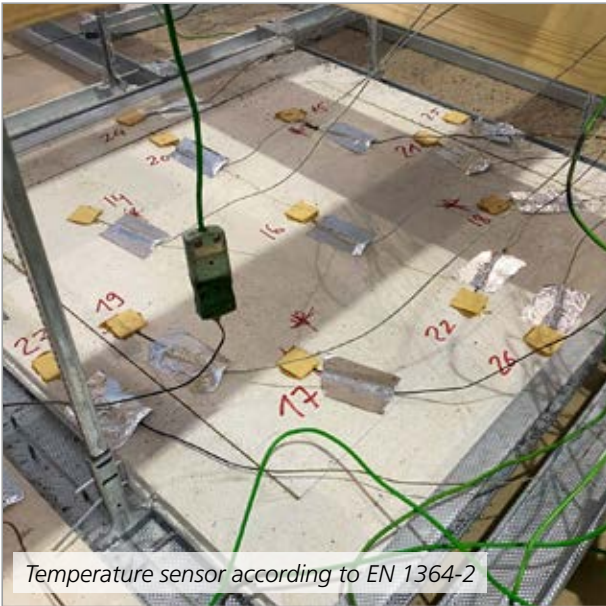

Temperature sensor according to EN 1364-2

Fire load on the ceiling top



Flaming of the ceiling top

FIREREV access panels for ceilings are tested for fire resistance according to EN 1364-2 in EI90, EI60 and EI30 suspended ceiling constructions as well as in EI120 rigid ceilings and are classified according to EN 13501-2.



Fire resistance test according to European standards in a suspended ceiling construction

Tested smoke tightness



Smoke tightness test according to European standards

FIREREV access panels not only stand for reliable fire protection, but also for maximum smoke tightness – tested according to EN 1634-3. The tests were carried out across all standard dimensions, from 200x200 xmm to 800x1200 mm, and confirm reliable sealing against both cold and warm smoke.

As part of the smoke tightness test, the access panels were installed in a defined wall construction in order to determine the leakage rate under various differential pressures – both on the shaft side and on the opposite shaft side.



The tightness was tested under two conditions:

- **S_a classification**
Room temperature at approximately 20 °C (cold smoke)
- **S₂₀₀ classification**
Elevated temperature of approx. 200°C (warm smoke)
- The test method according to ÖNORM EN 1634-3 measures the passage of air or smoke from one side of the opening to the other.

The result: FIREREV access panels meet the requirements of the S₂₀₀ classification and thus ensure a controlled leakage rate within the permissible limits – even under thermal stress.



room page



shaft side

Tested sound insulation



FIREREV access panels impress with their excellent sound insulation properties, tested according to ISO 10140.

For the sound test, the inspection opening locks were integrated into a standardised wall construction in order to determine the sound insulation under realistic conditions. The measurement was carried out on the basis of ÖNORM EN ISO 10140, which evaluates the acoustic behaviour of components under defined laboratory conditions.

The result: FIREREV access panels have virtually no impact on the sound insulation rating of the wall construction and thus contribute to optimised room acoustics – especially in areas where acoustic comfort plays a key role alongside fire protection, such e.g. in office buildings, public facilities or high-quality residential buildings.

FIREREV for walls



NEW!

Optionally available with stepped **EasyFIX**-Installation frame

- Simple front-side installation
- For 3x15mm GKF-Shaft walls

Further information can be found on page 28

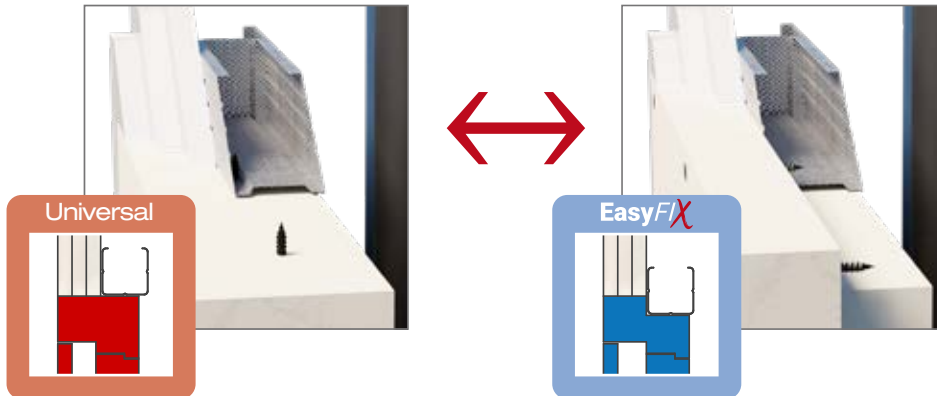

Optical covers
– suitable for every project

- Gypsum fibreboard, paintable
- White powder-coated metal cladding
- Snap fastener
- Square bolt lock



EasyFIX-Installation frame

NEW!

Easy to install and saves time

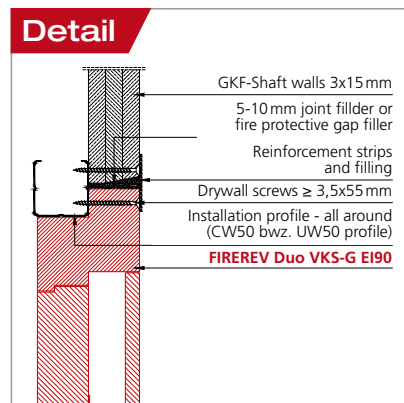

That's **FIX!**

Installation steps



Done!

*"Greater safety
through
simpler installation."*

Easy and secure installation

The newly developed, stepped **EasyFIX**-Installation frame for FIREREV access panels now makes installation even easier and more efficient – without compromising on safety.

**Save on installation time –
but not on safety**

The **EasyFIX**-Installation frame not only simplifies the installation of FIREREV access panels thanks to its front-side fastening, but also reduces installation time. This saves you valuable time and money.

Installation is completed in 3 simple steps:

1. Install CW profiles
2. Attach the FIREREV access panel to the CW profiles using the **EasyFIX**-Installation frame.
3. Fill joints

Stepped
EasyFIX-Installation frame
for front installation



Reverse side

Available versions



FIREREV Duo GPS-G
Page 46



FIREREV Duo VKS-G
Page 48



FIREREV Basic VKW-G
Page 50

Selection diagram

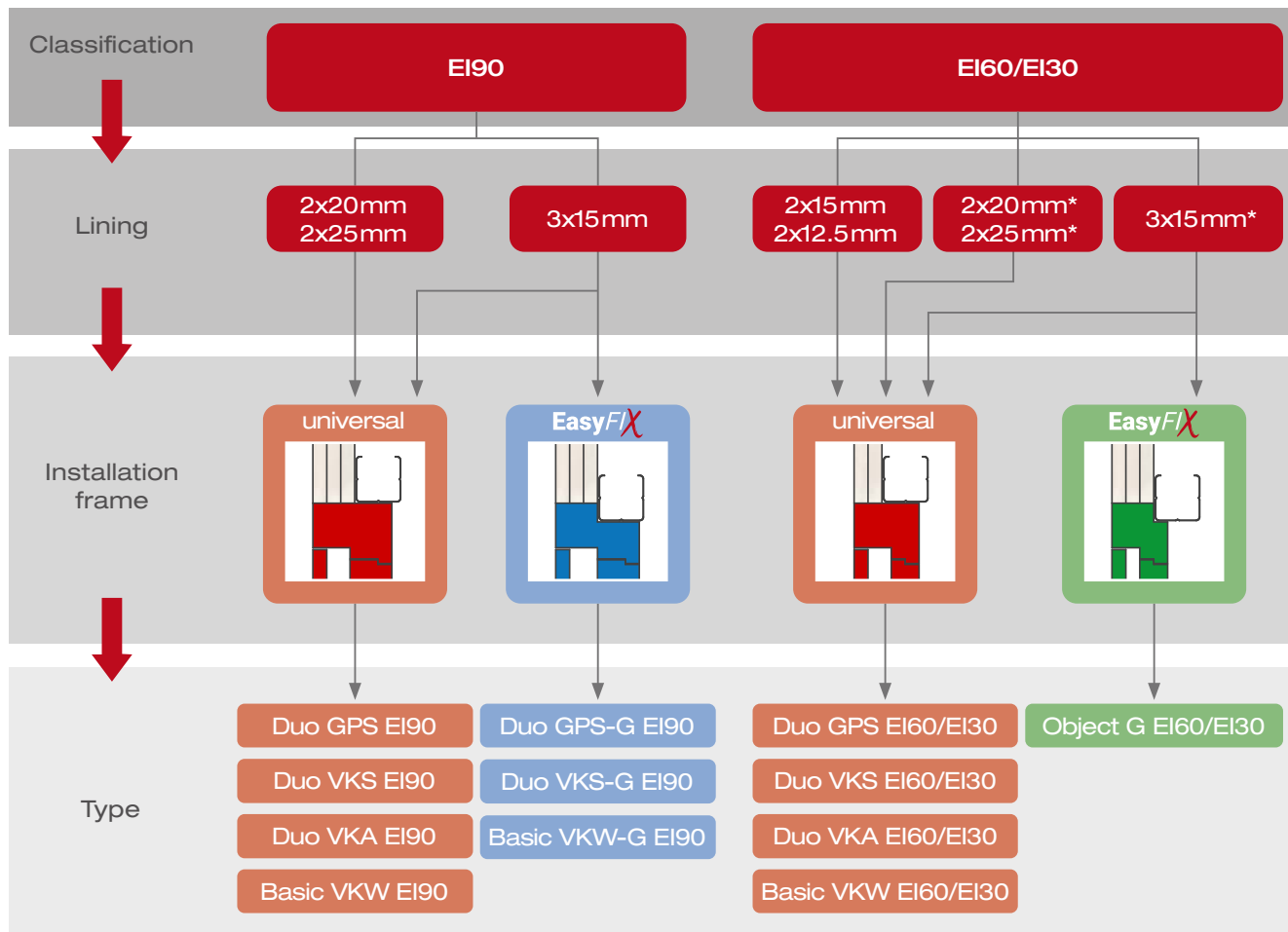

*Applies to construction projects in which Technical Guideline for Preventive Fire Protection (TRVB) 110 B is an integral part of the contract.

Universal installation frame



FIREREV Duo GPS
Visible cover:
Gypsum fibreboard
with snap lock

Page 34



FIREREV Duo VKS
Visible cover:
Gypsum fibreboard
with square bolt lock

Page 36



FIREREV Duo VKA
Visible cover:
Gypsum fibreboard
with square bolt lock,
removable

Page 38



FIREREV Duo VKA XL
Visible cover:
Gypsum fibreboard
with square bolt lock,
removable

Page 40



FIREREV Basic VKW
Visible cover:
Metal, white powder-coated
with square bolt lock

Page 42

EasyFIX-Installation frame



FIREREV Duo GPS-G
Visible cover:
Gypsum fibreboard
with snap lock

Page 46



FIREREV Duo VKS-G
Visible cover:
Gypsum fibreboard
with square bolt lock

Page 48



FIREREV Basic VKW-G
Visible cover:
Metal, white powder-coated
with square bolt lock

Page 50



FIREREV Object G
Visible cover:
Gypsum fibreboard
with square bolt lock,
removable

Page 54



FIREREV Object W
Visible cover:
Metal, white powder-coated
with square bolt lock

Page 56

Installation steps

Universal installation frame

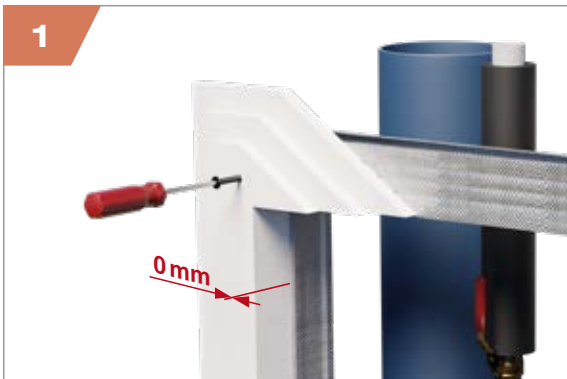
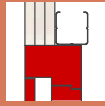

Attach mounting profiles **flush** with the wall opening all around.



Remove the fire lock cover and attach the installation frame to the installation profiles from the **inside**.



Fill the ring gap with joint filler or fire protective gap filler. Apply reinforcement strips and fill with filler.

EasyFIX-Installation frame

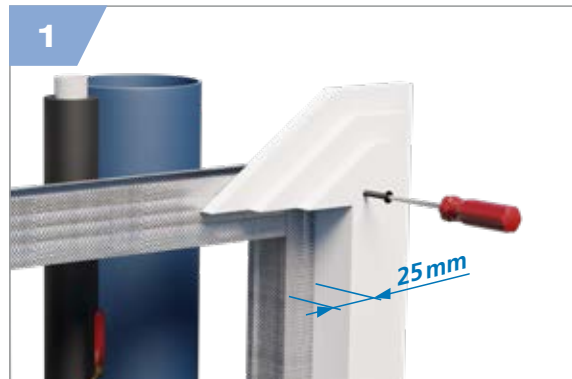
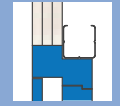

Attach mounting profiles all around with a **25 mm offset** to the inside of the wall opening.



Attach the mounting frame to the mounting profiles from the **room side**.



Fill the ring gap with joint filler or fire protective gap filler. Apply reinforcement strips and fill with filler.

Now also available with **EasyFix**-Installation frame!
Page 46

FIREREV Duo GPS

Visible cover: Gypsum fibreboard with snap lock



Benefits

- Paintable
- Easy to open and close with snap lock
- Special sizes for EI90 up to 600x800 mm

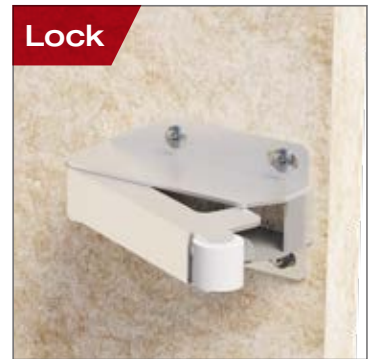

EI90 / EI60 / EI30

Standard sizes

From **200 x 200 mm** to **600 x 600 mm** (W x H)

Areas of application

- Shaft walls **EI90** – Lining 3x15 / 2x20 / 2x25 mm
- Shaft walls **EI60** – Lining 2x15 mm
- Shaft walls **EI30** – Lining 2x12.5 mm

Certificates



Classification report
MA 39 – 26-00406 (EI90)
MA 39 – 26-00408 (EI60/EI30)



VKF approval
No. 26007 (EI90)
No. 033313 (EI60)
No. 26003 (EI30)

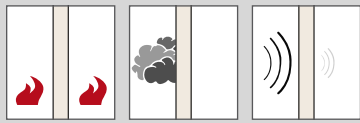

- ✓ Tested on both sides according to EN 1364-1
- ✓ Tested on both sides according to EN 1634-1
- ✓ Smoke-tight according to EN 1634-3
- ✓ Sound tested according to EN ISO 10140

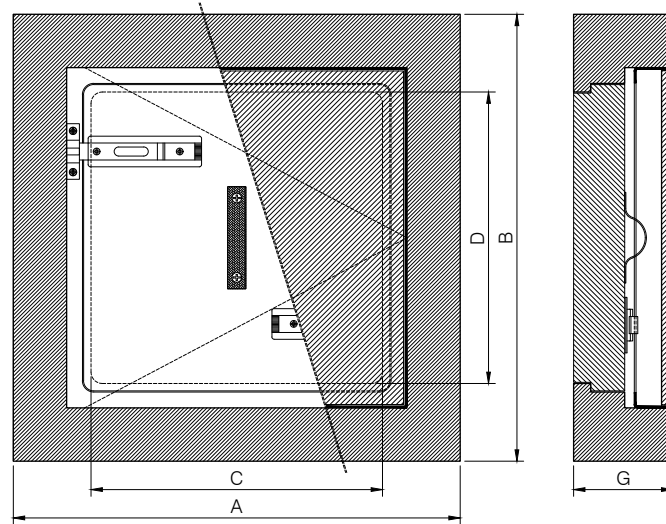
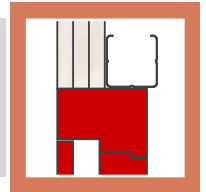

FIREREV Duo GPS

Fire resistance rating	Art.-No.	Type	Nominal size [mm×mm]	External dimensions A×B [mm×mm]	Pass-through C×D [mm×mm]	Depth G [mm]
EI90	6912020	REV/GPS-EI90/2020	200×200	294×294	157×157	90
	6913030	REV/GPS-EI90/3030	300×300	394×394	257×257	
	6914040	REV/GPS-EI90/4040	400×400	494×494	357×357	
	6915050	REV/GPS-EI90/5050	500×500	594×594	457×457	
	6916060	REV/GPS-EI90/6060	600×600	694×694	557×557	
EI60 EI30	6312020	REV/GPS-EI30_EI60/2020	200×200	294×294	157×157	75
	6313030	REV/GPS-EI30_EI60/3030	300×300	394×394	257×257	
	6314040	REV/GPS-EI30_EI60/4040	400×400	494×494	357×357	
	6315050	REV/GPS-EI30_EI60/5050	500×500	594×594	457×457	
	6316060	REV/GPS-EI30_EI60/6060	600×600	694×694	557×557	

Installation detail

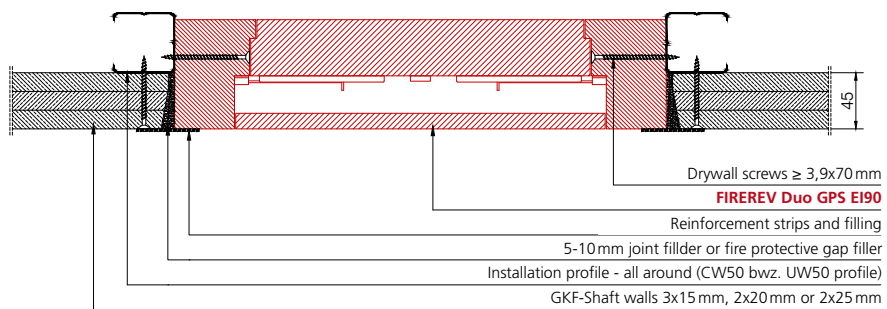

Now also available with **EasyFix**-Installation frame!
Page 48

FIREREV Duo VKS

Visible cover: Gypsum fibreboard with square bolt lock



Benefits

- Secure lock with square bolt lock
- Paintable
- Special sizes for EI90 to 600x800 mm

Installation

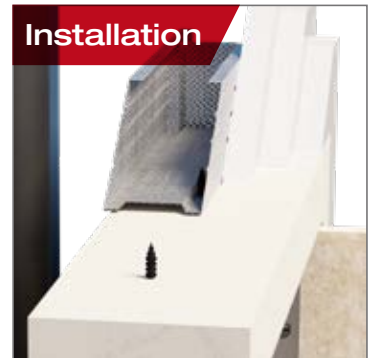

Lock



Hinges

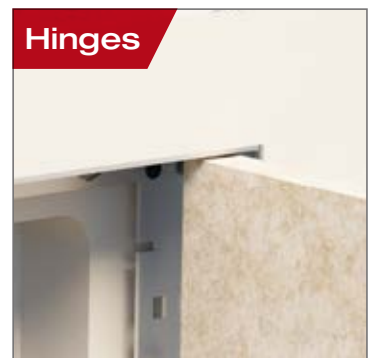

EI90 / EI60 / EI30

Standard sizes

From **200 x 200 mm** to **600 x 600 mm** (W x H)

Areas of application

- Shaft walls **EI90** – Lining 3x15 / 2x20 / 2x25 mm
- Shaft walls **EI60** – Lining 2x15 mm
- Shaft walls **EI30** – Lining 2x12.5 mm

Certificates



Classification report
MA 39 – 26-00406 (EI90)
MA 39 – 26-00408 (EI60/EI30)



VKF approval
No. 26007 (EI90)
No. 033313 (EI60)
No. 26003 (EI30)



abZ/abG
Z-6.55-2149 (EI90)
Z-6.55-2169 (EI30)

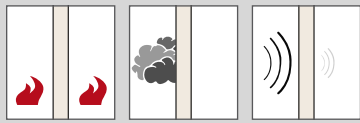

- ✓ Tested on both sides according to EN 1364-1
- ✓ Tested on both sides according to EN 1634-1
- ✓ Smoke-tight according to EN 1634-3
- ✓ Sound tested according to EN ISO 10140

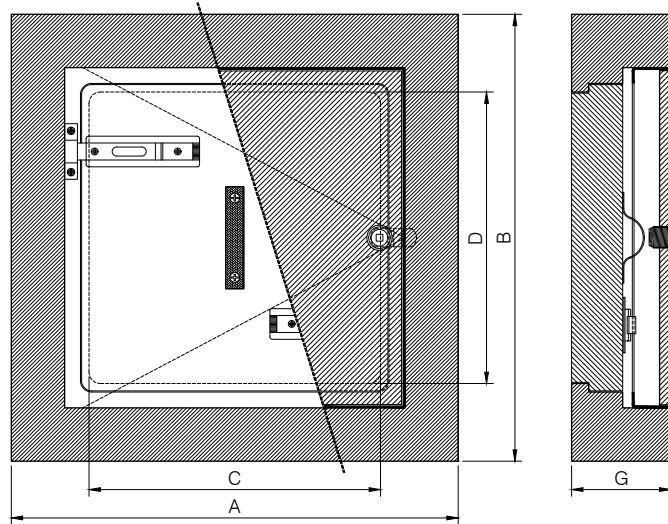
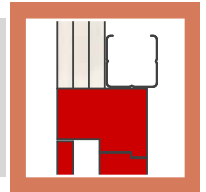

FIREREV Duo VKS

Fire resistance rating	Art.-No.	Type	Nominal size [mm×mm]	External dimensions A×B [mm×mm]	Pass-through C×D [mm×mm]	Depth G [mm]
EI90	6922020	REV/VKS-EI90/2020	200×200	294×294	157×157	90
	6923030	REV/VKS-EI90/3030	300×300	394×394	257×257	
	6924040	REV/VKS-EI90/4040	400×400	494×494	357×357	
	6925050	REV/VKS-EI90/5050	500×500	594×594	457×457	
	6926060	REV/VKS-EI90/6060	600×600	694×694	557×557	
EI60 EI30	6322020	REV/VKS-EI30_EI60/2020	200×200	294×294	157×157	75
	6323030	REV/VKS-EI30_EI60/3030	300×300	394×394	257×257	
	6324040	REV/VKS-EI30_EI60/4040	400×400	494×494	357×357	
	6325050	REV/VKS-EI30_EI60/5050	500×500	594×594	457×457	
	6326060	REV/VKS-EI30_EI60/6060	600×600	694×694	557×557	

Installation detail

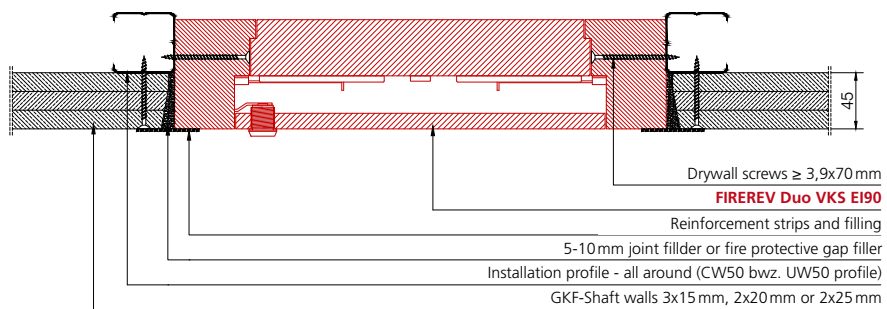

FIREREV Duo VKA

Visible cover: Removable gypsum fibreboard with square bolt lock



Benefits

- Secure lock with square bolt lock
- Paintable
- Special sizes for EI90 to 800x1200 mm



EI90 / EI60 / EI30

Standard sizes

From **200 x 200 mm** to **600 x 600 mm** (W x H)

Areas of application

- Shaft walls **EI90** – Lining 3x15 / 2x20 / 2x25 mm
- Shaft walls **EI60** – Lining 2x15 mm
- Shaft walls **EI30** – Lining 2x12.5 mm

Certificates

 **Classification report**
 MA 39 – 26-00406 (EI90)
 MA 39 – 26-00408 (EI60/EI30)

 **VKF approval**
 No. 26007 (EI90)
 No. 033313 (EI60)
 No. 26003 (EI30)

 **abZ/abG**
 Z-6.55-2149 (EI90)
 Z-6.55-2169 (EI30)

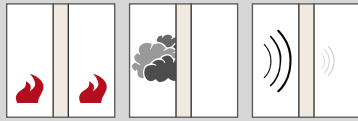

- ✓ Tested on both sides according to EN 1364-1
- ✓ Tested on both sides according to EN 1634-1
- ✓ Smoke-tight according to EN 1634-3
- ✓ Sound tested according to EN ISO 10140

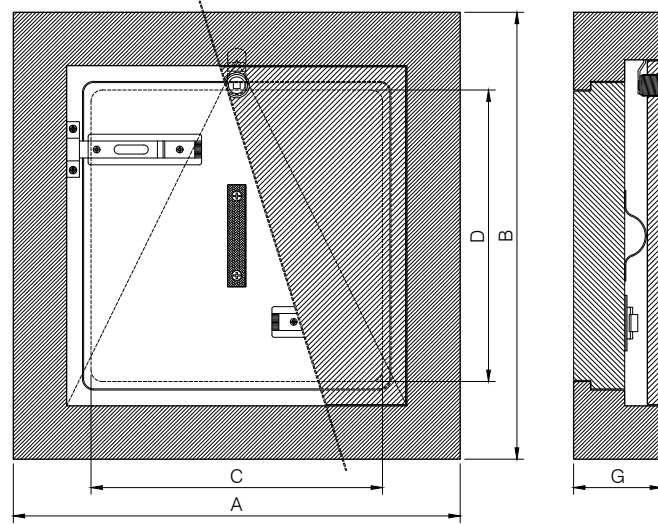
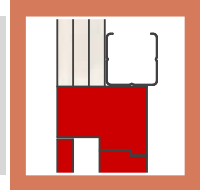

FIREREV Duo VKA

Fire resistance rating	Art.-No.	Type	Nominal size [mm×mm]	External dimensions A×B [mm×mm]	Pass-through C×D [mm×mm]	Depth G [mm]
E190	6952020	REV/VKA-EI90/2020	200×200	294×294	157×157	77,5
	6953030	REV/VKA-EI90/3030	300×300	394×394	257×257	
	6954040	REV/VKA-EI90/4040	400×400	494×494	357×357	
	6955050	REV/VKA-EI90/5050	500×500	594×594	457×457	
	6956060	REV/VKA-EI90/6060	600×600	694×694	557×557	
	6957070	REV/VKA-EI90/7070	700×700	794×794	657×657	97,5
	6957010	REV/VKA-EI90/7010	700×1000	794×1094	657×957	
	6958080	REV/VKA-EI90/8080	800×800	894×894	757×757	
	6958010	REV/VKA-EI90/80100	800×1000	894×1094	757×957	
	6958012	REV/VKA-EI90/80120	800×1200	894×1294	757×1157	
6951280	REV/VKA-EI90/12080	1200×800	1294×894	1157×757		
E160 EI30	6352020	REV/VKA-EI30_EI60/2020	200×200	294×294	157×157	62,5
	6353030	REV/VKA-EI30_EI60/3030	300×300	394×394	257×257	
	6354040	REV/VKA-EI30_EI60/4040	400×400	494×494	357×357	
	6355050	REV/VKA-EI30_EI60/5050	500×500	594×594	457×457	
	6356060	REV/VKA-EI30_EI60/6060	600×600	694×694	557×557	

Installation detail

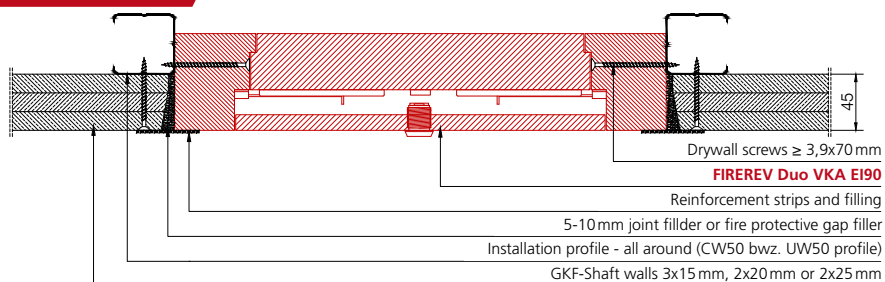



- ✓ Tested on both sides according to EN 1364-1
- ✓ Tested on both sides according to EN 1634-1
- ✓ Smoke-tight according to EN 1634-3

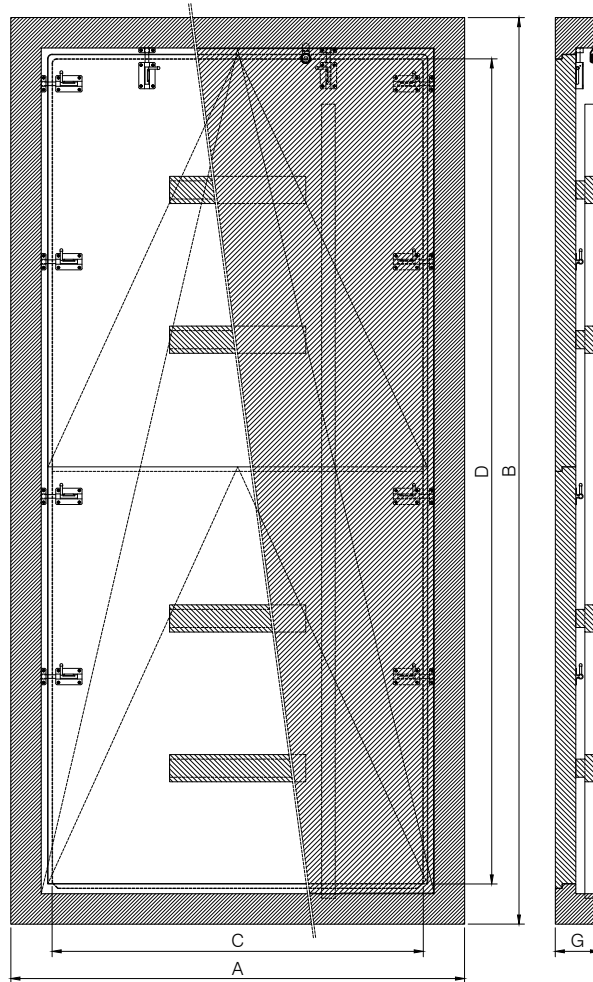
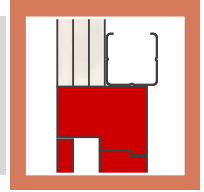

FIREREV Duo VKA XL

Fire resistance rating	Art.-No.	Type	Nominal size [mm×mm]	External dimensions A×B [mm×mm]	Pass-through C×D [mm×mm]	Depth G [mm]
EI90	9958013	REV/VKA-EI90/80130	800×1300	894×1394	718×1218	97,5
	9958518	REV/VKA-EI90/85185	850×1850	994×1994	818×1818	

Intermediate sizes available in 50mm increments.

Installation detail

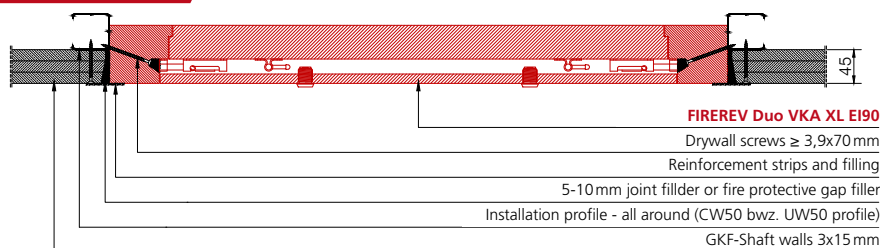

Now also available with
EasyFIX-Installation
 frame!
 Page 50

FIREREV Basic VKW

Visible cover: Metal, white powder-coated
 with square bolt lock



Benefits

- Secure lock with square bolt lock
- Metal cladding
- Special sizes for EI90 to 800x1200 mm



EI90 / EI60 / EI30

Standard sizes

From **200 x 200 mm** to **600 x 600 mm** (W x H)

Areas of application

- Shaft walls **EI90** – Lining 3x15 / 2x20 / 2x25 mm
- Shaft walls **EI60** – Lining 2x15 mm
- Shaft walls **EI30** – Lining 2x12.5 mm

Certificates

 **Classification report**
 MA 39 – 26-00406 (EI90)
 MA 39 – 26-00408 (EI60/EI30)

 **VKF approval**
 No. 26007 (EI90)
 No. 033313 (EI60)
 No. 26003 (EI30)

 **abZ/abG**
 Z-6.55-2149 (EI90)
 Z-6.55-2169 (EI30)

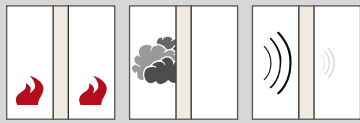

- ✓ Tested on both sides according to EN 1364-1
- ✓ Tested on both sides according to EN 1634-1
- ✓ Smoke-tight according to EN 1634-3
- ✓ Sound tested according to EN ISO 10140

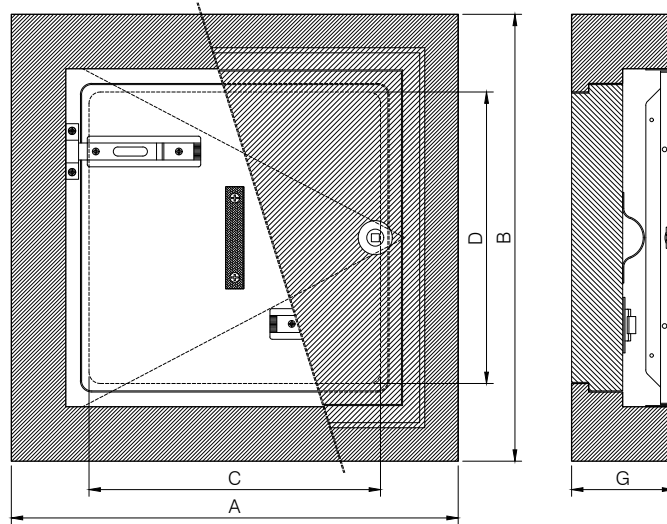
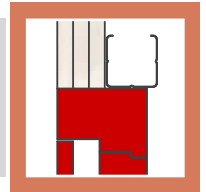

FIREREV Basic VKW

Fire resistance rating	Art.-No.	Type	Nominal size [mm×mm]	External dimensions A×B [mm×mm]	Pass-through C×D [mm×mm]	Depth G [mm]
EI90	9642003	REV/VKW-EI90/2020	200×200	294×294	157×157	90
	9643003	REV/VKW-EI90/3030	300×300	394×394	257×257	
	9644003	REV/VKW-EI90/4040	400×400	494×494	357×357	
	9645003	REV/VKW-EI90/5050	500×500	594×594	457×457	
	9646003	REV/VKW-EI90/6060	600×600	694×694	557×557	
EI60 EI30	9642053	REV/VKW-EI30_EI60/2020	200×200	294×294	157×157	75
	9643053	REV/VKW-EI30_EI60/3030	300×300	394×394	257×257	
	9644053	REV/VKW-EI30_EI60/4040	400×400	494×494	357×357	
	9645053	REV/VKW-EI30_EI60/5050	500×500	594×594	457×457	
	9646053	REV/VKW-EI30_EI60/6060	600×600	694×694	557×557	

Installation detail

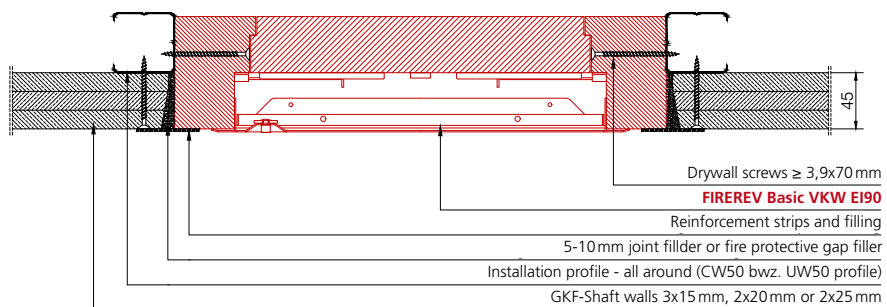

FIREREV Basic VKW-M for rigid walls

Visible cover: Metal, white powder-coated with square bolt lock



Benefits

- For rigid walls from 100 mm
- Metal cladding
- Secure lock with square bolt lock

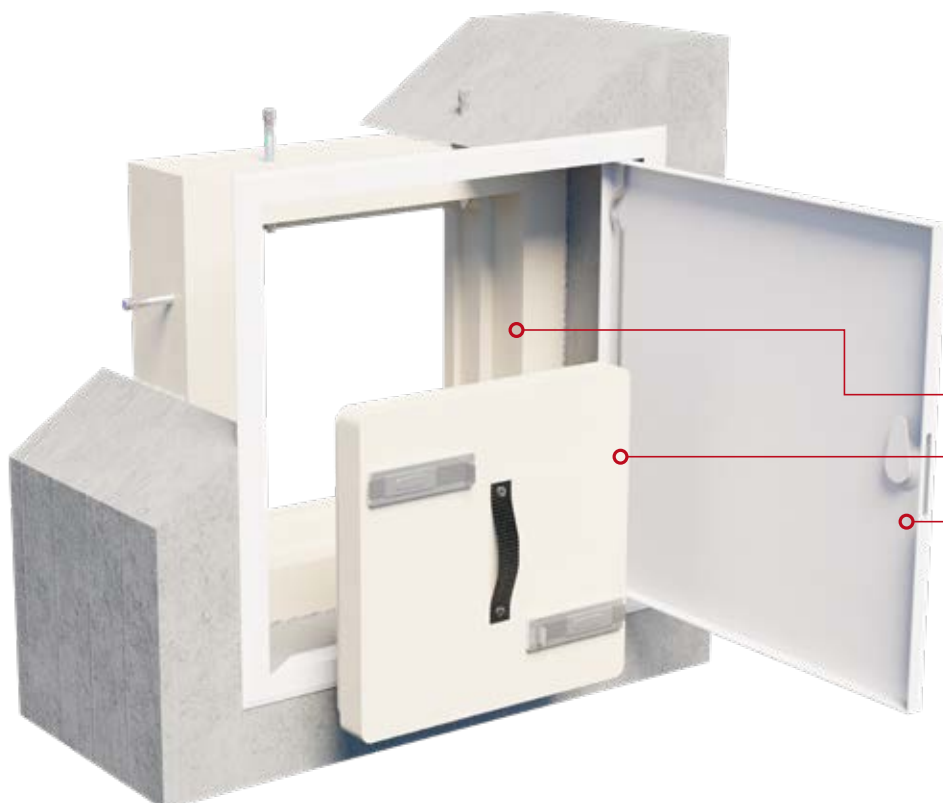

- Fire lock
- Fire lock cover
- Visible cover

E120 / E190

Standard sizes

For building openings measuring **500 x 500 mm** to **700 x 700 mm**

Areas of application

- **Rigid walls E120** – thickness ≥ 100 mm, density ≥ 500 kg/m³

Certificates

Classification report
MA 39 – 26-00406 (E190)



Accessories:

BFM/K310 fire protective gap filler

To seal the remaining gap between FIREREV and the ceiling.
Item no. 9900001





- ✓ Tested on both sides according to EN 1364-1
- ✓ Tested on both sides according to EN 1634-1
- ✓ Smoke-tight according to EN 1634-3

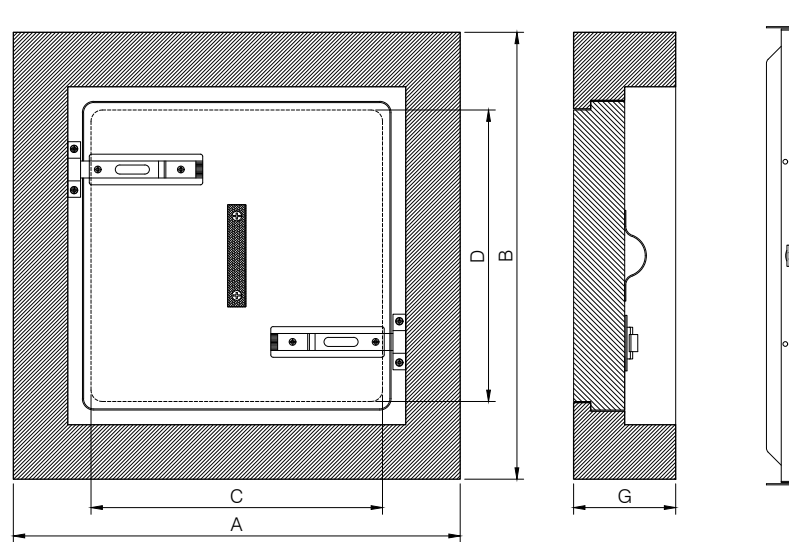
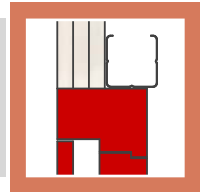

FIREREV Basic VKW-M

Fire resistance rating	Art.-No.	Type	Shell construction - opening	Pass-through	Depth
			AxB [mmxmm]	CxD [mmxmm]	G [mm]
EI90	9644005	REV/VKW-M-EI90/4040	500x500	357x357	90
	9645006	REV/VKW-M-EI90/5050	600x600	457x457	
	9646007	REV/VKW-M-EI90/6060	700x700	557x557	

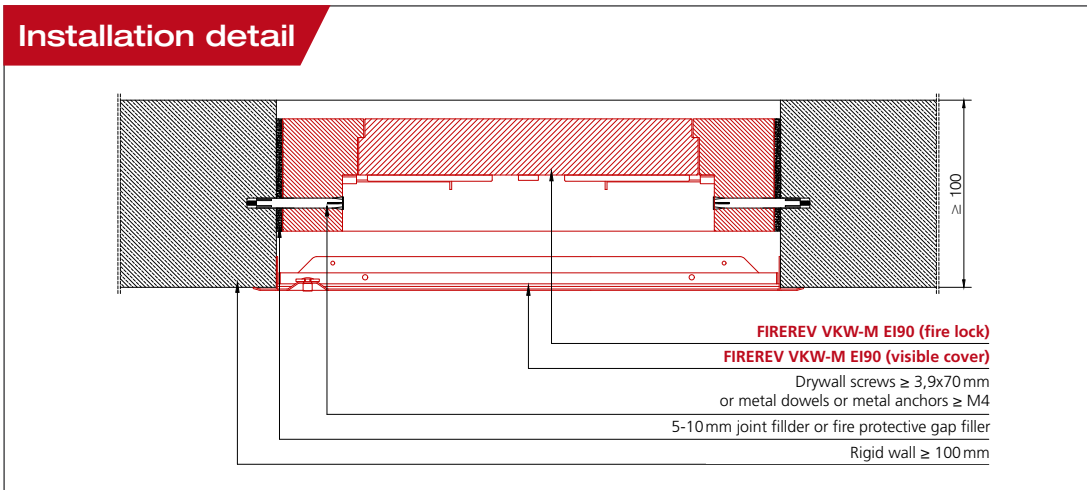

**NOW
NEW!**

EasyFIX-Installation frame

FIREREV Duo GPS-G

With stepped EasyFIX-Installation frame for 3x15 mm GKF-Shaft walls

Visible cover: Gypsum fibreboard with snap lock



Benefits

- Simple and efficient installation through EasyFIX-installation frame
- Paintable
- Easy to open and close with snap lock

Installation



Lock

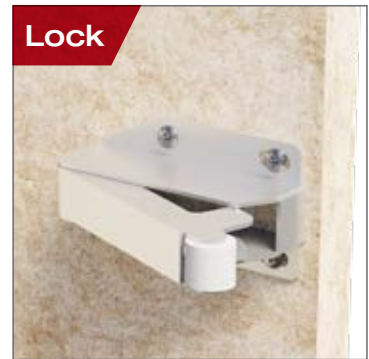

Hinges



EI90

Standard sizes

From 200x200 mm to 600x600 mm (WxH)

Areas of application

- Shaft walls EI90 – Lining 3x15 mm

Certificates



Classification report
MA 39 – 26-00406 (EI90)

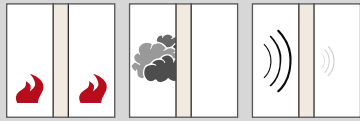

- ✓ Tested on both sides according to EN 1364-1
- ✓ Tested on both sides according to EN 1634-1
- ✓ Smoke-tight according to EN 1634-3
- ✓ Sound tested according to EN ISO 10140

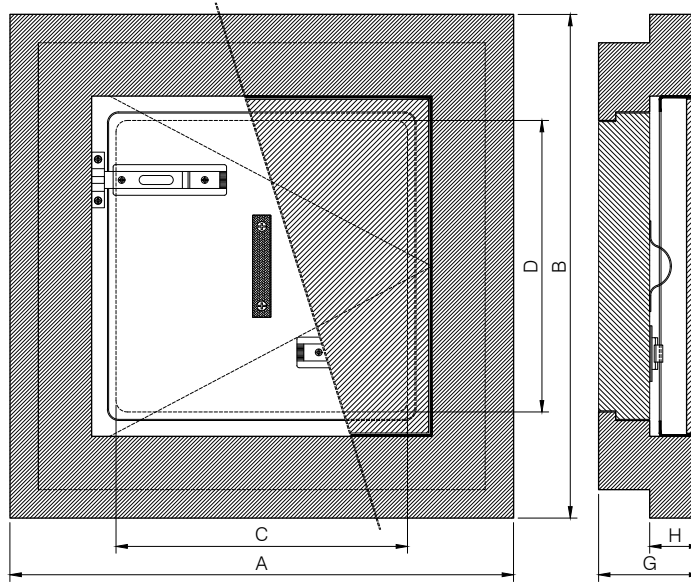
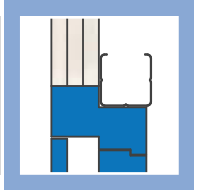

FIREREV Duo GPS-G

Fire resistance rating	Art.-No.	Type	Nominal size [mm×mm]	External dimensions A×B [mm×mm]	Pass-through C×D [mm×mm]	Depth	
						G [mm]	H [mm]
EI90	69120201	REV/GPS-G-EI90/2020	200×200	344×344	157×157	90	45
	69130301	REV/GPS-G-EI90/3030	300×300	444×444	257×257		
	69140401	REV/GPS-G-EI90/4040	400×400	544×544	357×357		
	69150501	REV/GPS-G-EI90/5050	500×500	644×644	457×457		
	69160601	REV/GPS-G-EI90/6060	600×600	744×744	557×557		

Installation detail

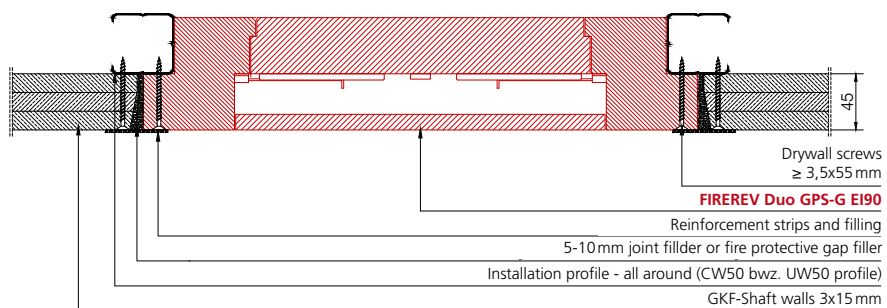

**NOW
NEW!**

EasyFIX-Installation frame

FIREREV Duo VKS-G

With stepped EasyFIX-Installation frame for 3x15 mm GKF-Shaft walls

Visible cover: Gypsum fibreboard with square bolt lock



Benefits

- Simple and efficient installation through EasyFIX-installation frame
- Paintable
- Secure lock with square bolt lock

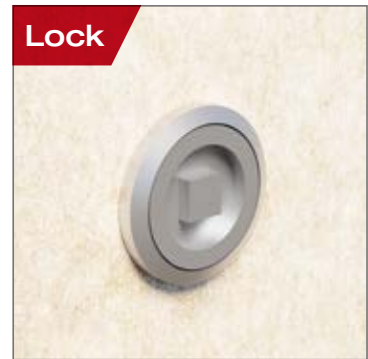

EI90

Standard sizes

From 200x200 mm to 600x600 mm (WxH)

Areas of application

- Shaft walls EI90 – Lining 3x15 mm

Certificates

 **Classification report**
MA 39 – 26-00406 (EI90)

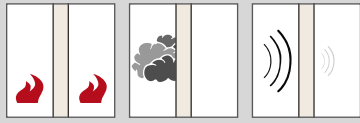

- ✓ Tested on both sides according to EN 1364-1
- ✓ Tested on both sides according to EN 1634-1
- ✓ Smoke-tight according to EN 1634-3
- ✓ Sound tested according to EN ISO 10140

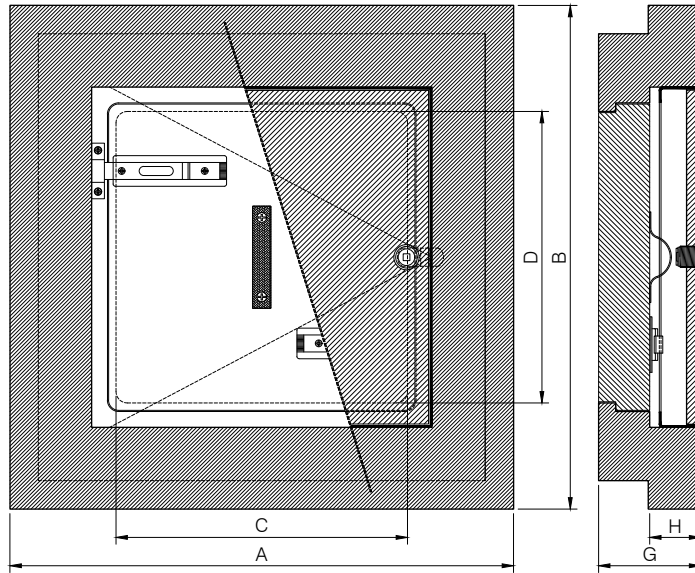
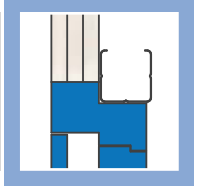

FIREREV Duo VKS-G

Fire resistance rating	Art.-No.	Type	Nominal size [mm×mm]	External dimensions A×B [mm×mm]	Pass-through C×D [mm×mm]	Depth	
						G [mm]	H [mm]
EI90	69220201	REV/VKS-G-EI90/2020	200×200	344×344	157×157	90	45
	69230301	REV/VKS-G-EI90/3030	300×300	444×444	257×257		
	69240401	REV/VKS-G-EI90/4040	400×400	544×544	357×357		
	69250501	REV/VKS-G-EI90/5050	500×500	644×644	457×457		
	69260601	REV/VKS-G-EI90/6060	600×600	744×744	557×557		

Installation detail

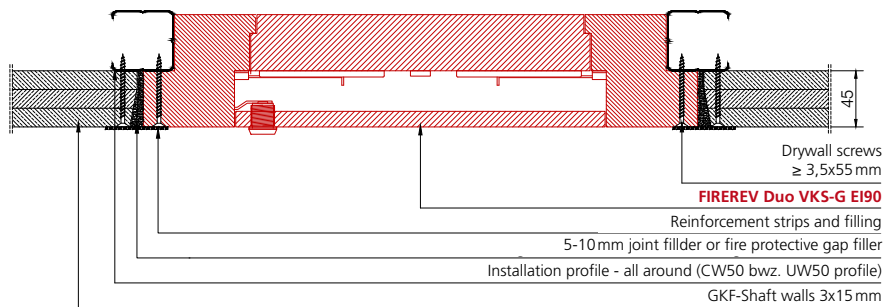

**NOW
NEW!**

EasyFIX-Installation frame

FIREREV Basic VKW-G

With stepped EasyFIX-Installation frame for 3x15 mm GKF-Shaft walls

Visible cover: Metal, white powder-coated with square bolt lock



Benefits

- Simple and efficient installation through EasyFIX-installation frame
- Metal cladding
- Secure lock with square bolt lock



EI90

Standard sizes

From 200x200 mm to 600x600 mm (WxH)

Areas of application

- Shaft walls EI90 – Lining 3x15 mm

Certificates



Classification report
MA 39 – 26-00406 (EI90)

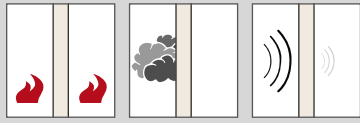

- ✓ Tested on both sides according to EN 1364-1
- ✓ Tested on both sides according to EN 1634-1
- ✓ Smoke-tight according to EN 1634-3
- ✓ Sound tested according to EN ISO 10140

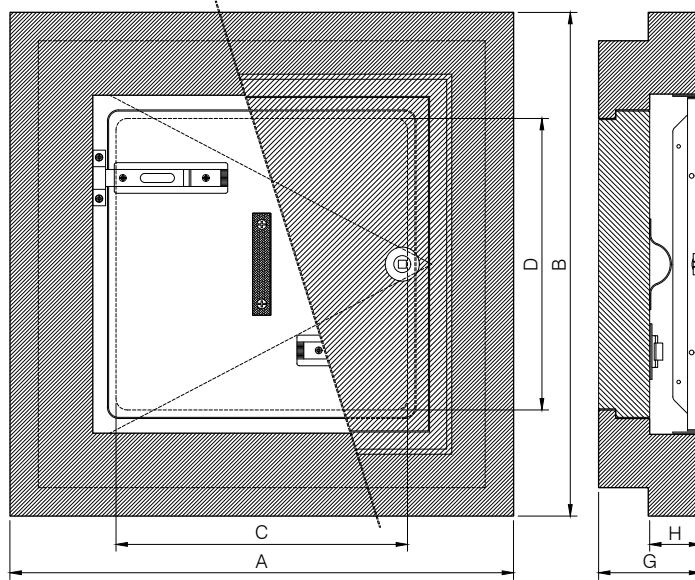
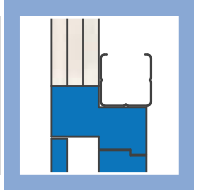

FIREREV Basic VKW-G

Fire resistance rating	Art.-No.	Type	Nominal size [mm×mm]	External dimensions A×B [mm×mm]	Pass-through C×D [mm×mm]	Depth	
						G [mm]	H [mm]
EI90	96420031	REV/VKW-G-EI90/2020	200×200	344×344	157×157	90	45
	96430031	REV/VKW-G-EI90/3030	300×300	444×444	257×257		
	96440031	REV/VKW-G-EI90/4040	400×400	544×544	357×357		
	96450031	REV/VKW-G-EI90/5050	500×500	644×644	457×457		
	96460031	REV/VKW-G-EI90/6060	600×600	744×744	557×557		

Installation detail

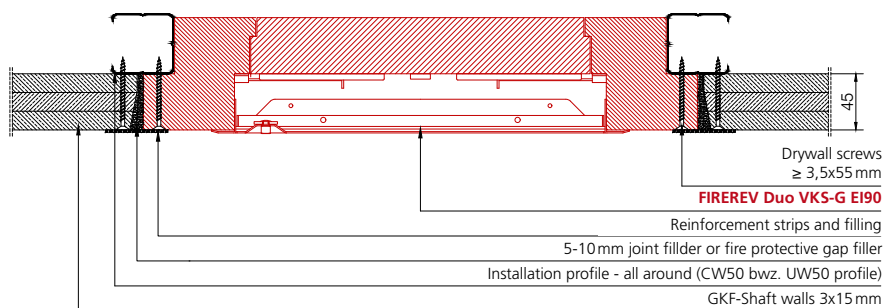

**NOW
NEW!**

EasyFIX-Installation frame

FIREREV Duo GPS-G WC50

With stepped **EasyFIX-Installation frame** for WC modules in 3x15 mm GKF-Shaft walls

Visible cover: Gypsum fibreboard with snap lock



Benefits

- Optimised **EasyFIX-Installation frame** for mounting with WC modules
- Efficient use of space about WC modules
- Secure attachment to CW profiles

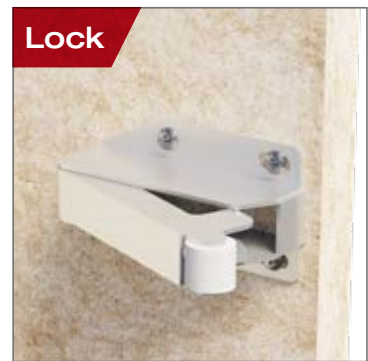

The **FIREREV Duo GPS-G WC50** access panel is the ideal solution for simple and secure installation above WC modules. The specially adapted frame ensures stable attachment to the CW profiles. The application-oriented design allows for the largest possible pass-through and ensures convenient access to the meter and shut-off units behind it.

EI90

Standard sizes

From **400x400 mm** to **400x600 mm** (WxH)

Areas of application

- Shaft walls **EI90** – Lining 3x15 mm

Certificates

Classification report
MA 39 – 26-00406 (EI90)

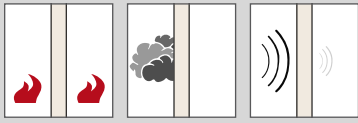

- ✓ Tested on both sides according to EN 1364-1
- ✓ Tested on both sides according to EN 1634-1
- ✓ Smoke-tight according to EN 1634-3
- ✓ Sound tested according to EN ISO 10140

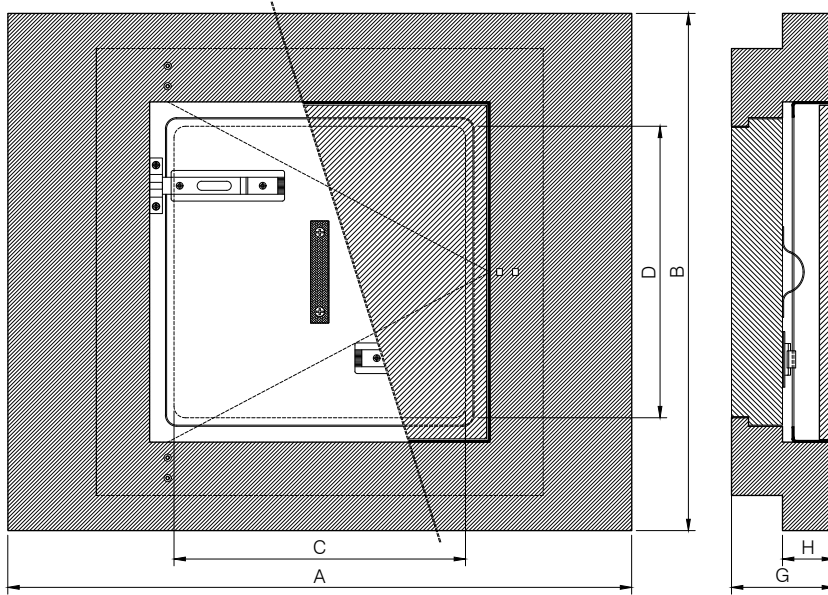
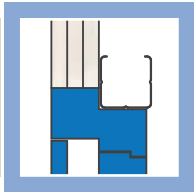

FIREREV Duo GPS-G WC50

Fire resistance rating	Art.-No.	Type	Nominal size [mm×mm]	External dimensions A×B [mm×mm]	Pass-through C×D [mm×mm]	Depth G [mm]	Lining H [mm]
EI90	4914040	REV/GPS-G-WC50-EI90/4040	400×400	630×550	342×357	90	45
	4914060	REV/GPS-G-WC50-EI90/4060	400×600	630×750	342×557		

Installation detail

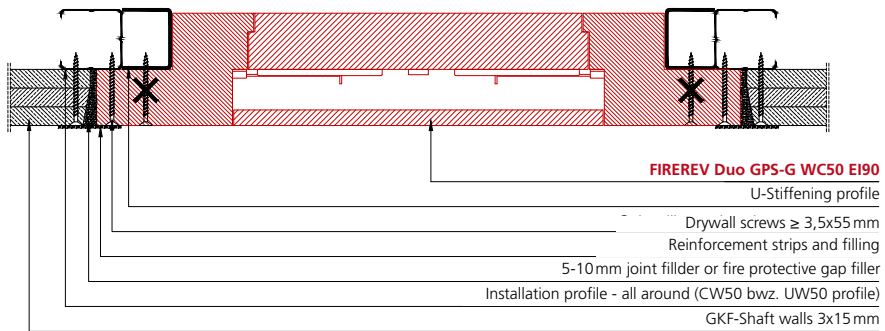

FIREREV Object G

With stepped EasyFIX-Installation frame for 3x15 mm* GKF-Shaft walls

Visible cover: Removable gypsum fibreboard with square bolt lock



Benefits

- Simple and efficient installation through EasyFIX-Installation frame
- Secure lock with square bolt lock
- Paintable

Installation

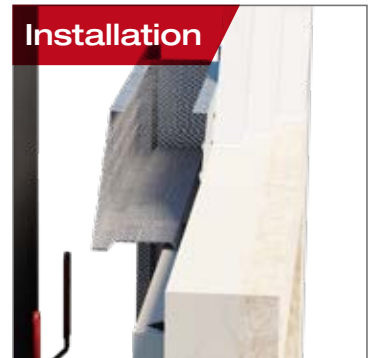

Lock



Hinges



EI60 / EI30

Standard sizes

From 300x300 mm to 600x600 mm (WxH)

Areas of application

- Shaft walls EI90 – Lining 3x15 mm*

Certificates



Classification report
MA 39 – 21-09323

*Applies to construction projects with Technical Guideline for Preventive Fire Protection (TRVB) 110 B as part of the contract.

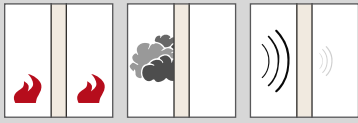

- ✓ Tested on both sides according to EN 1364-1
- ✓ Tested on both sides according to EN 1634-1
- ✓ Smoke-tight according to EN 1634-3
- ✓ Sound tested according to EN ISO 10140

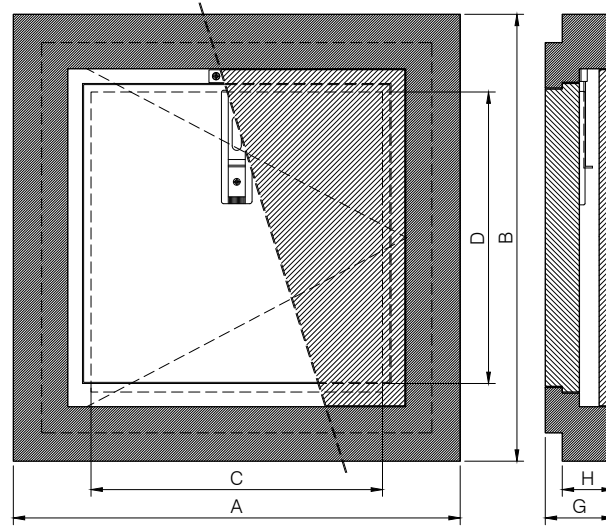
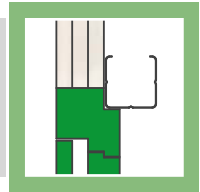

FIREREV Object G

Fire resistance rating	Art.-No.	Type	Nominal size [mm×mm]	External dimensions A×B [mm×mm]	Pass-through C×D [mm×mm]	Lining	
						G [mm]	H [mm]
EI60 EI30	5603030	REV/OBJ/G-EI60/3030	300×300	394×394	270×277	60	45
	5604040	REV/OBJ/G-EI60/4040	400×400	494×494	370×377		
	5605050	REV/OBJ/G-EI60/5050	500×500	594×594	457×457		
	5606060	REV/OBJ/G-EI60/6060	600×600	694×694	557×557		

Installation detail

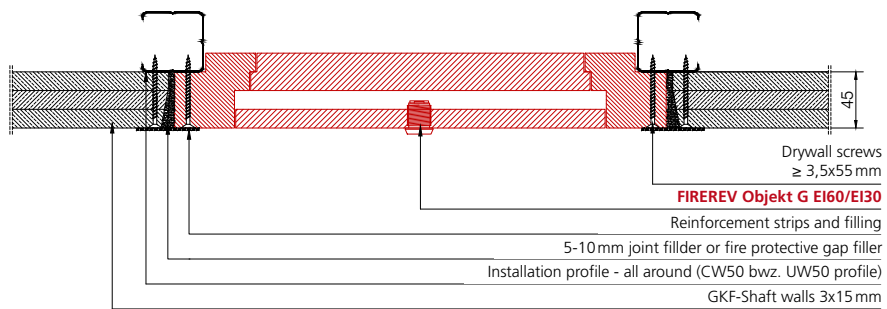

FIREREV Object W

With stepped EasyFIX-Installation frame for 3x15 mm* GKF-Shaft walls

Visible cover: Metal, white powder-coated with square bolt lock

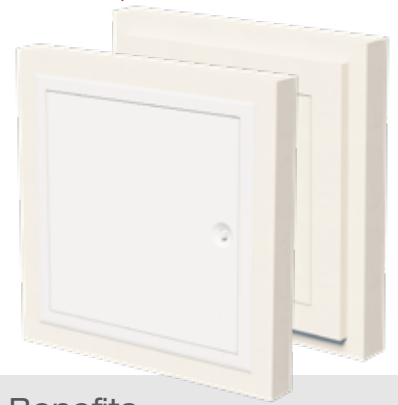
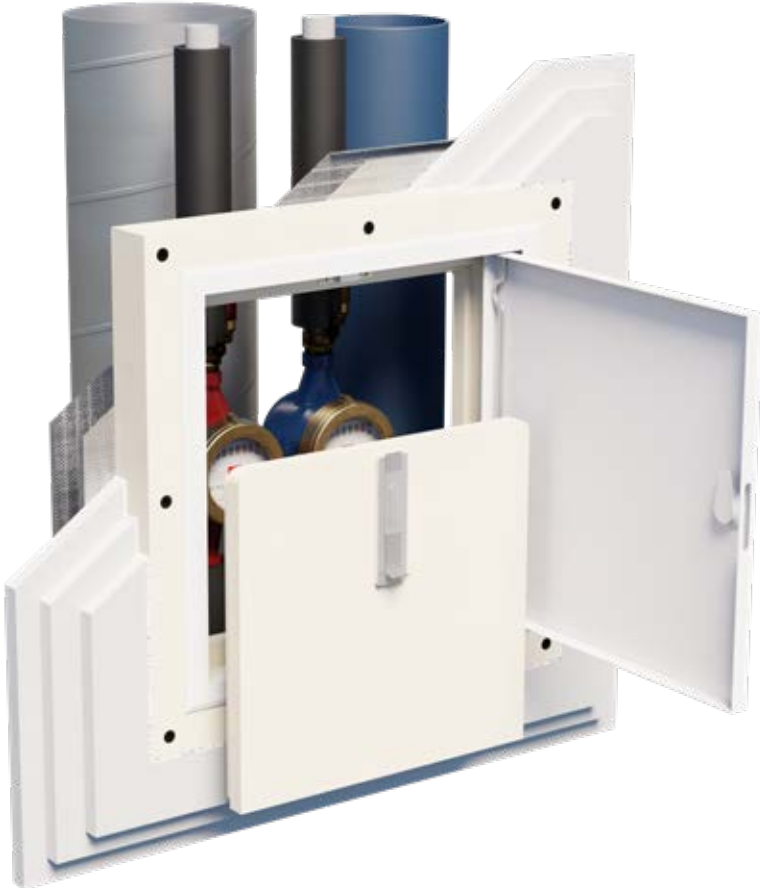

Benefits

- Simple and efficient installation through EasyFIX-installation frame
- Secure lock with square bolt lock
- Metal cladding

Installation

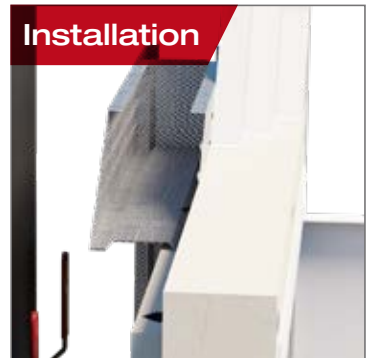

Lock



Hinges



EI60 / EI30

Standard sizes

From 300x300 mm to 600x600 mm (WxH)

Areas of application

- Shaft walls EI90 – Lining 3x15 mm*

Certificates



Classification report
MA 39 – 21-09323

*Applies to construction projects with Technical Guideline for Preventive Fire Protection (TRVB) 110 B as part of the contract.

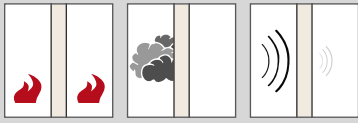

- ✓ Tested on both sides according to EN 1364-1
- ✓ Tested on both sides according to EN 1634-1
- ✓ Smoke-tight according to EN 1634-3
- ✓ Sound tested according to EN ISO 10140

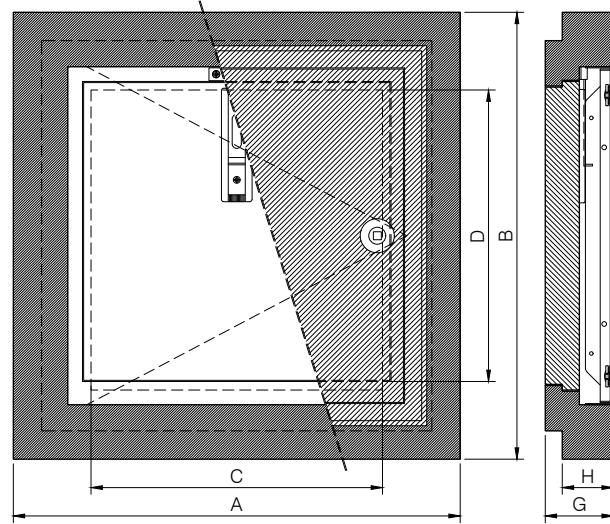
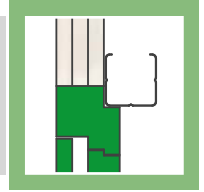

FIREREV Object W

Fire resistance rating	Item no.	Type	Nominal size [mm×mm]	External dimensions A×B [mm×mm]	Pass-through C×D [mm×mm]	Depth	
						G [mm]	H [mm]
EI60 EI30	6603030	REV/OBJ/G-EI60/3030	300×300	394×394	270×277	60	45
	6604040	REV/OBJ/G-EI60/4040	400×400	494×494	370×377		
	6605050	REV/OBJ/G-EI60/5050	500×500	594×594	457×457		
	6606060	REV/OBJ/G-EI60/6060	600×600	694×694	557×557		

Installation detail

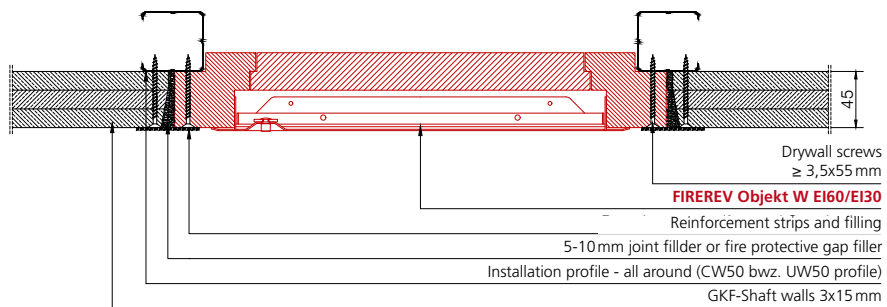

FIREREV for ceilings





Integrated fire protection

- Fire protection tested on both sides – No additional fire protection sets or plasterboard doubling required



Stable hinge connection

- Secure hold of the fire closure lid



Catch lock

- Protects the flap from uncontrolled opening, thereby providing additional security.



Installation – FIREREV for ceilings

Profile arrangement

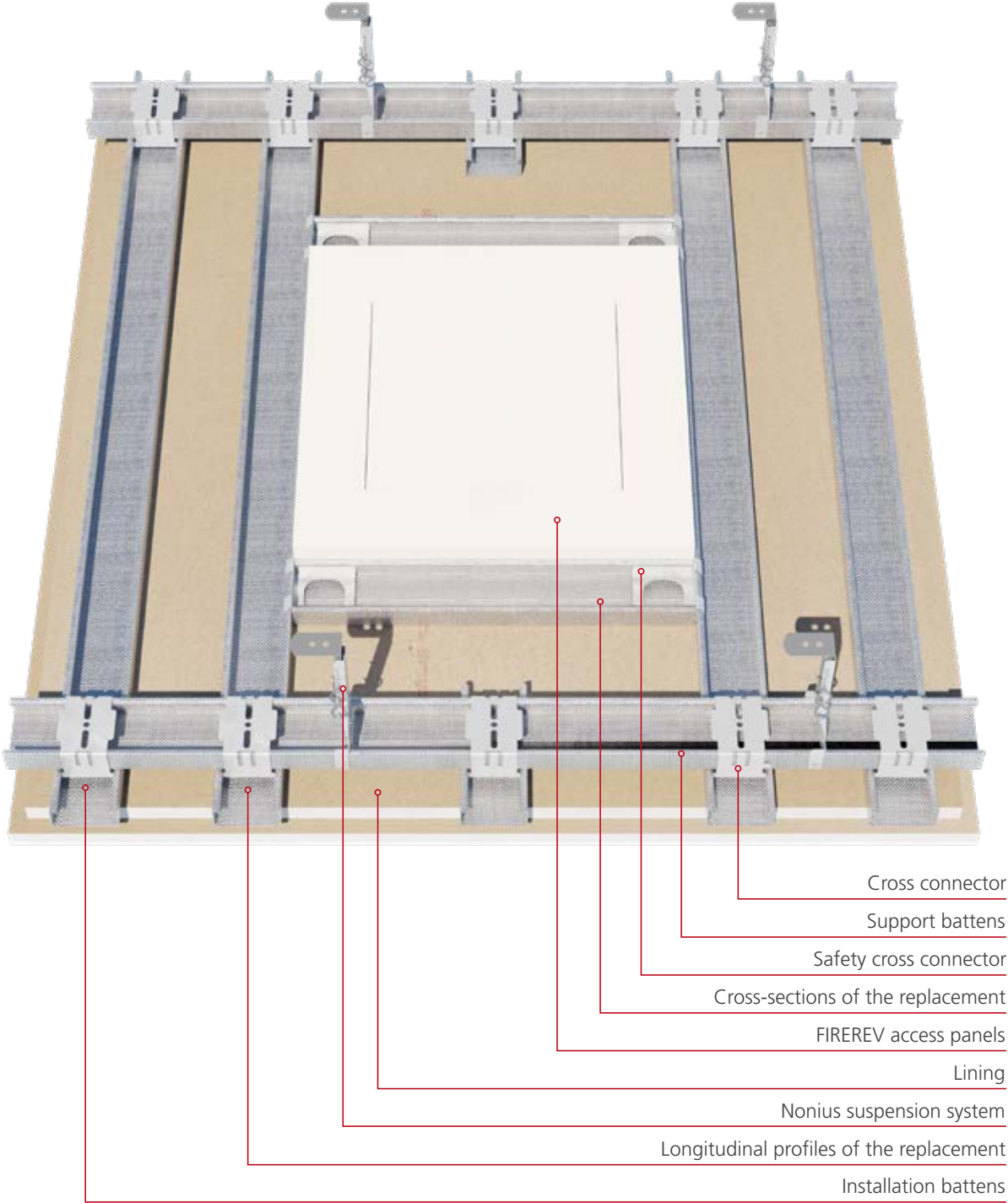

Installation steps

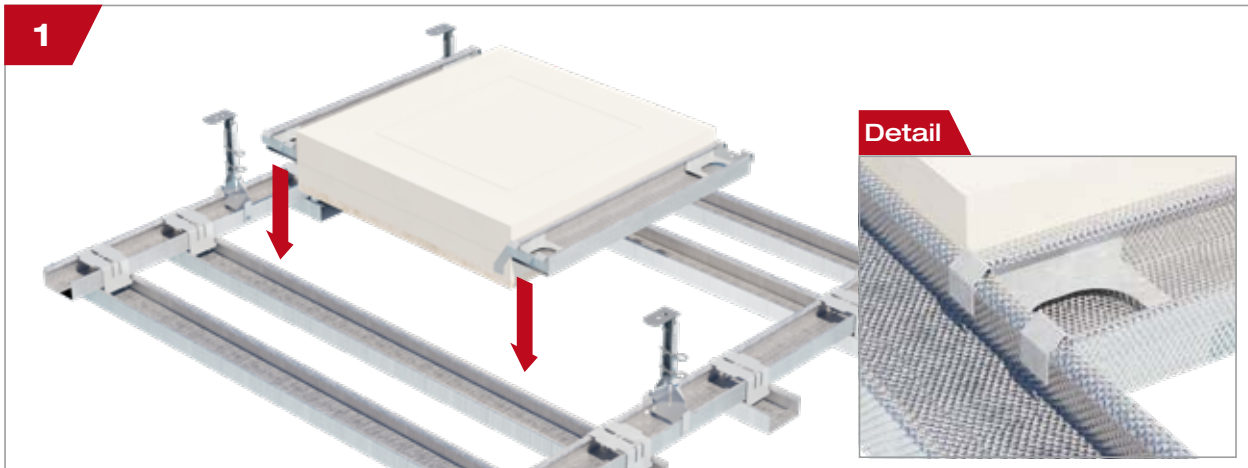

Replace the suspended ceiling construction. Attach cross profiles of the replacement to 2 sides of the access panel. Hook the cross profiles onto the longitudinal profiles using safety cross connectors.

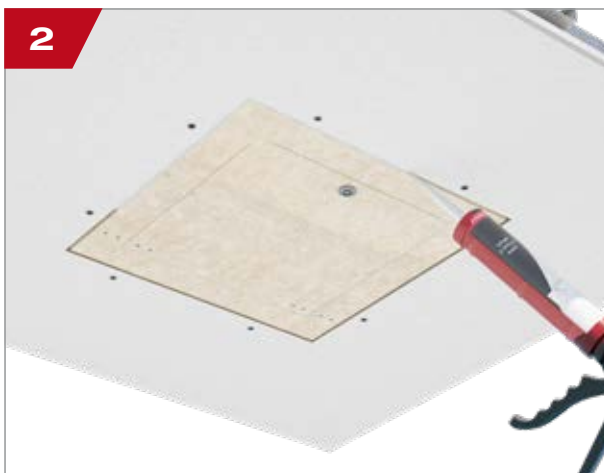

Plank the GKF suspended ceiling construction and fill the ring gap with joint filler or fire protective gap filler.



Apply reinforcement strips and fill with filler.

Further information on the installation and assembly of FIREREV access panels can be found in our "FIREREV ceiling installation instructions" according to the classification report.



PDF download:
installation instructions





✓ Tested on both sides according to EN 1364-2

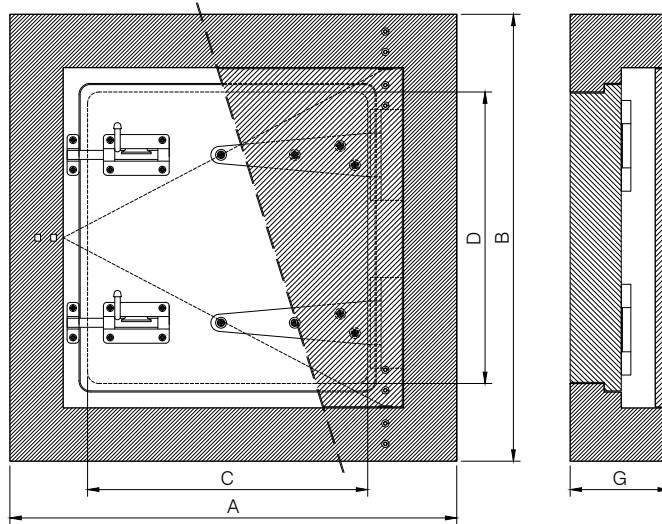
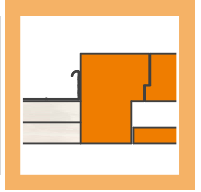

FIREREV Duo DE/GPS						
Fire resistance rating	Art.-No.	Type	Nominal size [mm×mm]	External dimensions A×B [mm×mm]	Pass-through C×D [mm×mm]	Depth G [mm]
EI90	6192020	REV/EN/GPS-EI90/2020	200×200	294×294	147×157	87,5
	6193030	REV/EN/GPS-EI90/3030	300×300	394×394	247×257	
	6194040	REV/EN/GPS-EI90/4040	400×400	494×494	347×357	
	6195050	REV/EN/GPS-EI90/5050	500×500	594×594	447×457	
	6196060	REV/EN/GPS-EI90/6060	600×600	694×694	547×557	
EI60	6162020	REV/EN/GPS-EI60/2020	200×200	294×294	147×157	72,5
	6163030	REV/EN/GPS-EI60/3030	300×300	394×394	247×257	
	6164040	REV/EN/GPS-EI60/4040	400×400	494×494	347×357	
	6165050	REV/EN/GPS-EI60/5050	500×500	594×594	447×457	
	6166060	REV/EN/GPS-EI60/6060	600×600	694×694	547×557	
EI30	6132020	REV/EN/GPS-EI30/2020	200×200	294×294	147×157	72,5
	6133030	REV/EN/GPS-EI30/3030	300×300	394×394	247×257	
	6134040	REV/EN/GPS-EI30/4040	400×400	494×494	347×357	
	6135050	REV/EN/GPS-EI30/5050	500×500	594×594	447×457	
	6136060	REV/EN/GPS-EI30/6060	600×600	694×694	547×557	

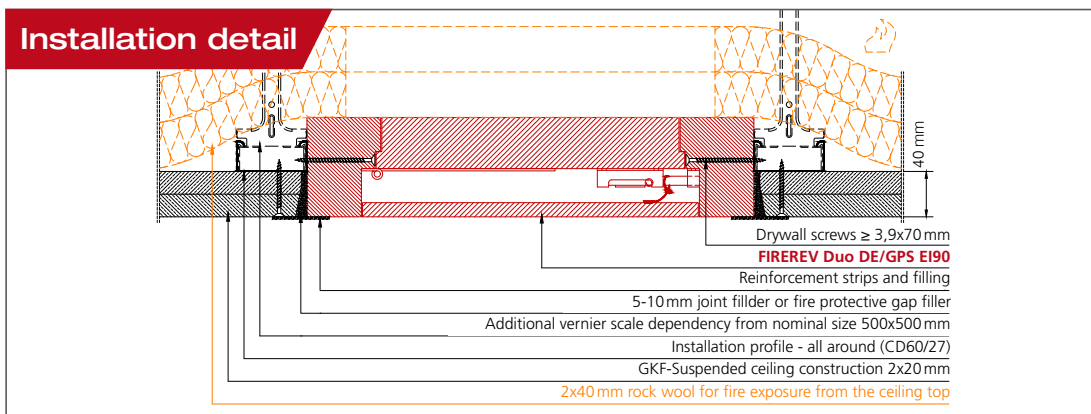



✓ Tested on both sides according to EN 1364-2

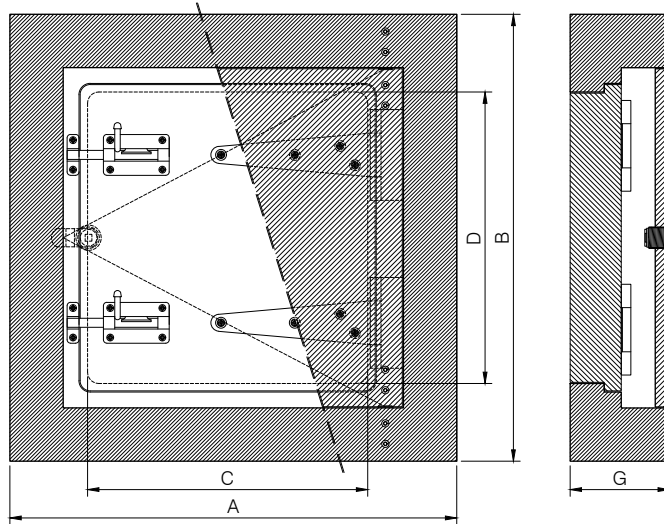
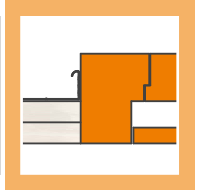

FIREREV Duo DE/VKS

Fire resistance rating	Art.-No.	Type	Nominal size [mm×mm]	External dimensions A×B [mm×mm]	Pass-through C×D [mm×mm]	Depth G [mm]
EI90	6922002	REV/EN/VKS-EI90/2020	200×200	294×294	147×157	87,5
	6923003	REV/EN/VKS-EI90/3030	300×300	394×394	247×257	
	6924004	REV/EN/VKS-EI90/4040	400×400	494×494	347×357	
	6925005	REV/EN/VKS-EI90/5050	500×500	594×594	447×457	
	6926006	REV/EN/VKS-EI90/6060	600×600	694×694	547×557	
EI60	6622002	REV/EN/VKS-EI60/2020	200×200	294×294	147×157	72,5
	6623003	REV/EN/VKS-EI60/3030	300×300	394×394	247×257	
	6624004	REV/EN/VKS-EI60/4040	400×400	494×494	347×357	
	6625005	REV/EN/VKS-EI60/5050	500×500	594×594	447×457	
	6626006	REV/EN/VKS-EI60/6060	600×600	694×694	547×557	
EI30	6322002	REV/EN/VKS-EI30/2020	200×200	294×294	147×157	72,5
	6323003	REV/EN/VKS-EI30/3030	300×300	394×394	247×257	
	6324004	REV/EN/VKS-EI30/4040	400×400	494×494	347×357	
	6325005	REV/EN/VKS-EI30/5050	500×500	594×594	447×457	
	6326006	REV/EN/VKS-EI30/6060	600×600	694×694	547×557	

Installation detail

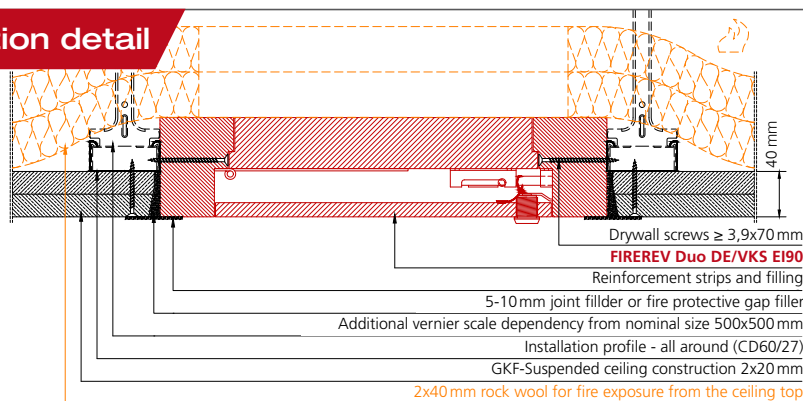

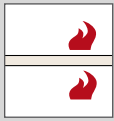

✓ Tested on both sides according to EN 1364-2

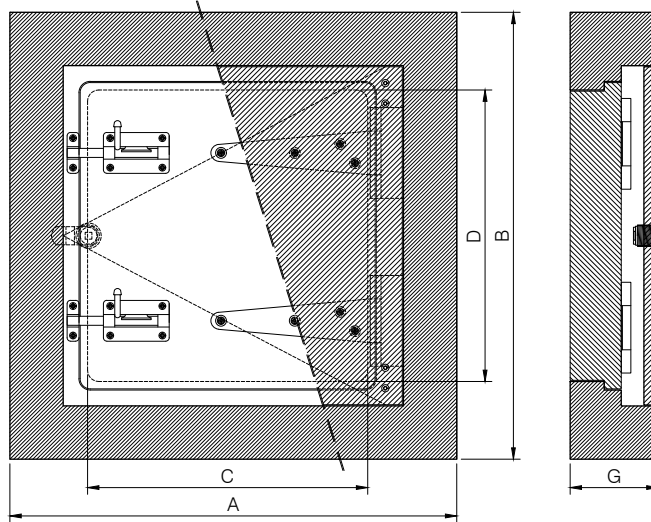
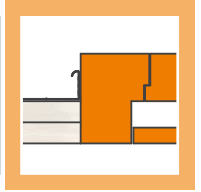

FIREREV Duo DE/VKA						
Fire resistance rating	Art.-No.	Type	Nominal size [mm×mm]	External dimensions A×B [mm×mm]	Pass-through C×D [mm×mm]	Depth G [mm]
EI90	6292020	REV/EN/VKA-EI90/2020	200×200	294×294	147×157	77,5
	6293030	REV/EN/VKA-EI90/2020	300×300	394×394	247×257	
	6294040	REV/EN/VKA-EI90/4040	400×400	494×494	347×357	
	6295050	REV/EN/VKA-EI90/5050	500×500	594×594	447×457	
	6296060	REV/EN/VKA-EI90/6060	600×600	694×694	547×557	
EI60	6262020	REV/EN/VKA-EI60/2020	200×200	294×294	147×157	62,5
	6263030	REV/EN/VKA-EI60/3030	300×300	394×394	247×257	
	6264040	REV/EN/VKA-EI60/4040	400×400	494×494	347×357	
	6265050	REV/EN/VKA-EI60/5050	500×500	594×594	447×457	
	6266060	REV/EN/VKA-EI60/6060	600×600	694×694	547×557	
EI30	6232020	REV/EN/VKA-EI30/2020	200×200	294×294	147×157	62,5
	6233030	REV/EN/VKA-EI30/3030	300×300	394×394	247×257	
	6234040	REV/EN/VKA-EI30/4040	400×400	494×494	347×357	
	6235050	REV/EN/VKA-EI30/5050	500×500	594×594	447×457	
	6236060	REV/EN/VKA-EI30/6060	600×600	694×694	547×557	

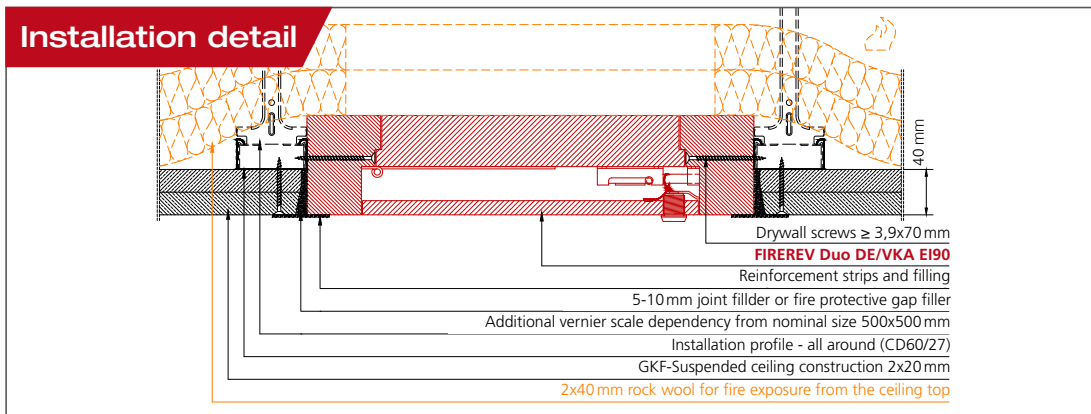

FIREREV Basic DE/VKW-M for rigid ceilings

Visible cover: Metal,
white powder-coated with square bolt lock

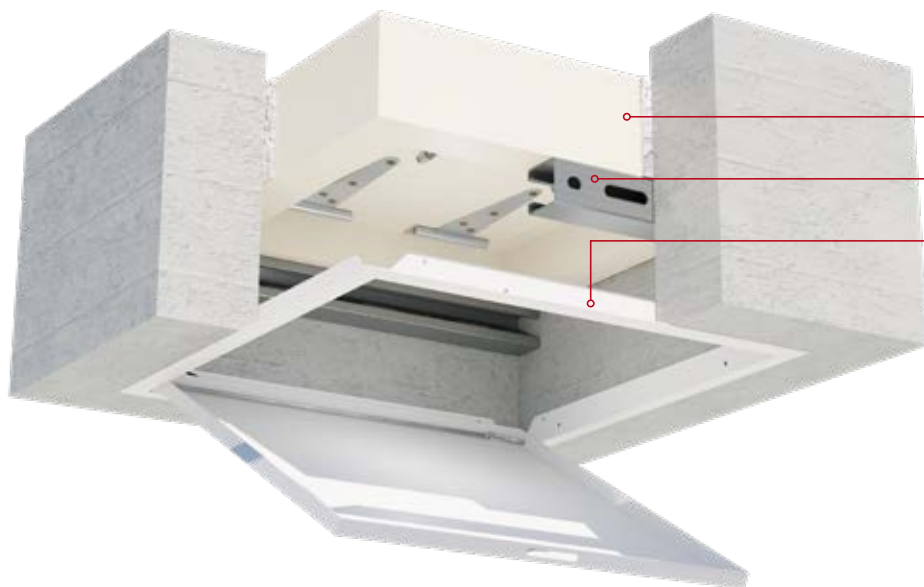

- Fire lock
- Mounting profile
- Visible cover

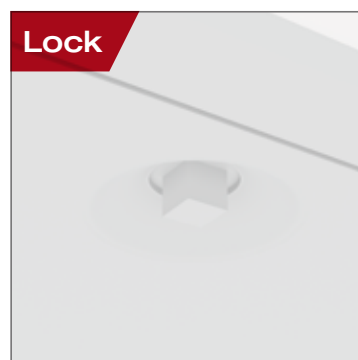

E120 / E190

Standard sizes

For building openings measuring **500 x 500 mm** to **700 x 700 mm**

Areas of application

- **Rigid ceiling E120** – thickness ≥ 150 mm, density ≥ 500 kg/m³

Accessories:

BFM/K310 fire protective gap filler

To seal the remaining gap between FIREREV and the ceiling.
Item no. 9900001





✓ Tested on both sides according to EN 1364-2

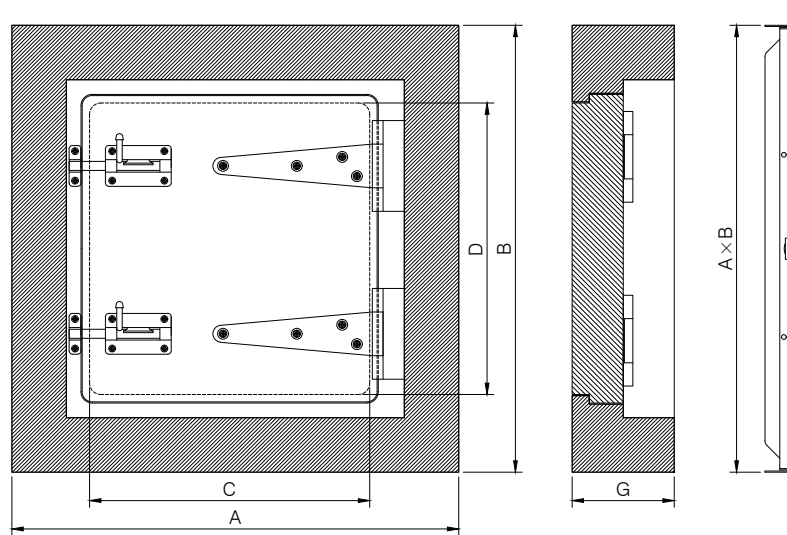
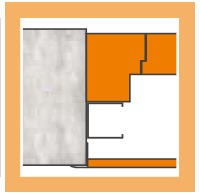

FIREREV Basic EN/VKW-M

Fire resistance rating	Art.-No.	Type	Shell construction - opening	Pass-through	Depth
			AxB [mmxmm]	CxD [mmxmm]	G [mm]
EI90	9644045	REV/EN/VKW-M-EI90/4040	500x500	347x357	90
	9645046	REV/EN/VKW-M-EI90/5050	600x600	447x457	
	9646047	REV/EN/VKW-M-EI90/6060	700x700	547x557	

Installation detail

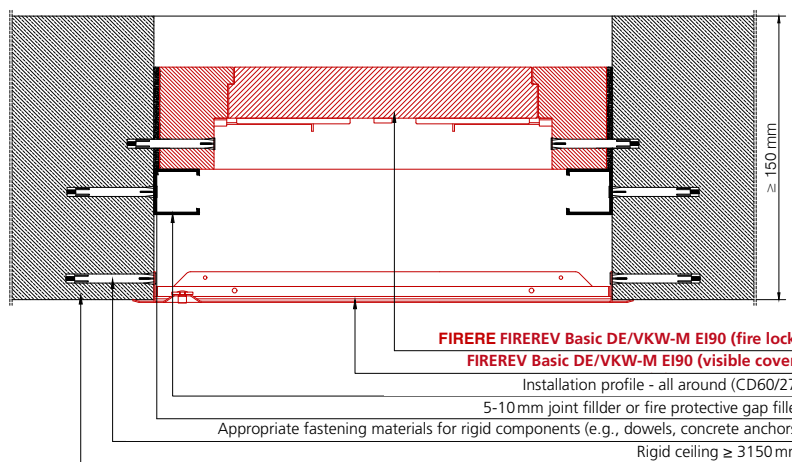



Mixed penetration seal TIROTECH®

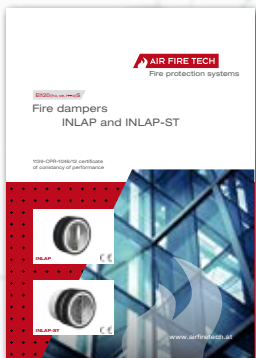

INLAP and INLAP-ST fire dampers



Further documents can be found at www.airfiretech.at.

© AIR FIRE TECH Fire Protection Systems Ltd.
FIREREV fire protection access panels, February 2026

All information in this brochure is based on the latest developments and has been compiled for you to the best of our knowledge and belief. As we always strive to offer you the best possible solutions, we reserve the right to make changes due to improvements in application or production technology. Please ensure that you have the latest edition of this brochure. Typographical and printing errors cannot be ruled out.

Air Fire Tech products generally have higher quality characteristics than required by the applicable technical standards. Unless expressly stated otherwise, the information in this brochure does not imply compatibility with third-party products or systems; no warranty or liability can be assumed in this regard.

Please also note that our business relationships are based exclusively on our current General Terms and Conditions of Sale, Delivery and Payment (GTC). Our GTC can be found on the Internet at www.airfiretech.at or are available on request.

We look forward to working with you!

Air Fire Tech Fire Protection Systems Ltd.



Fire protection systems



Hanschgasse 1 / Top 4A
2540 Bad Vöslau
Austria
T: +43 1 982 01 74-0
F: +43 1 982 01 74-930
E: office@airfiretech.at

Now available!

**FIREREV
Duo VKA XL**
up to 1x2m



Download
Brochure

www.airfiretech.at